

RALLS COUNTY R-II SCHOOL DISTRICT

# PARKING LOT EXPANSION

21622 HIGHWAY 19, CENTER, MISSOURI 63436

**FOR USE BY:**  
THE BOARD OF EDUCATION OF  
RALLS COUNTY R-II SCHOOL DISTRICT  
21622 HIGHWAY 19  
CENTER, MISSOURI 63436

**CONSTRUCTION DOCUMENTS  
ISSUED FOR BIDDING**  
**04/24/2020**



DR. TARA LEWIS, SUPERINTENDENT

SCHOOL BOARD:  
LORI ROBINSON  
MICHAEL BOLING  
RONALD EVANS  
RITCHIE PALMER  
DANIEL CLARK  
PETE HILGENBRINK  
JASON LITER

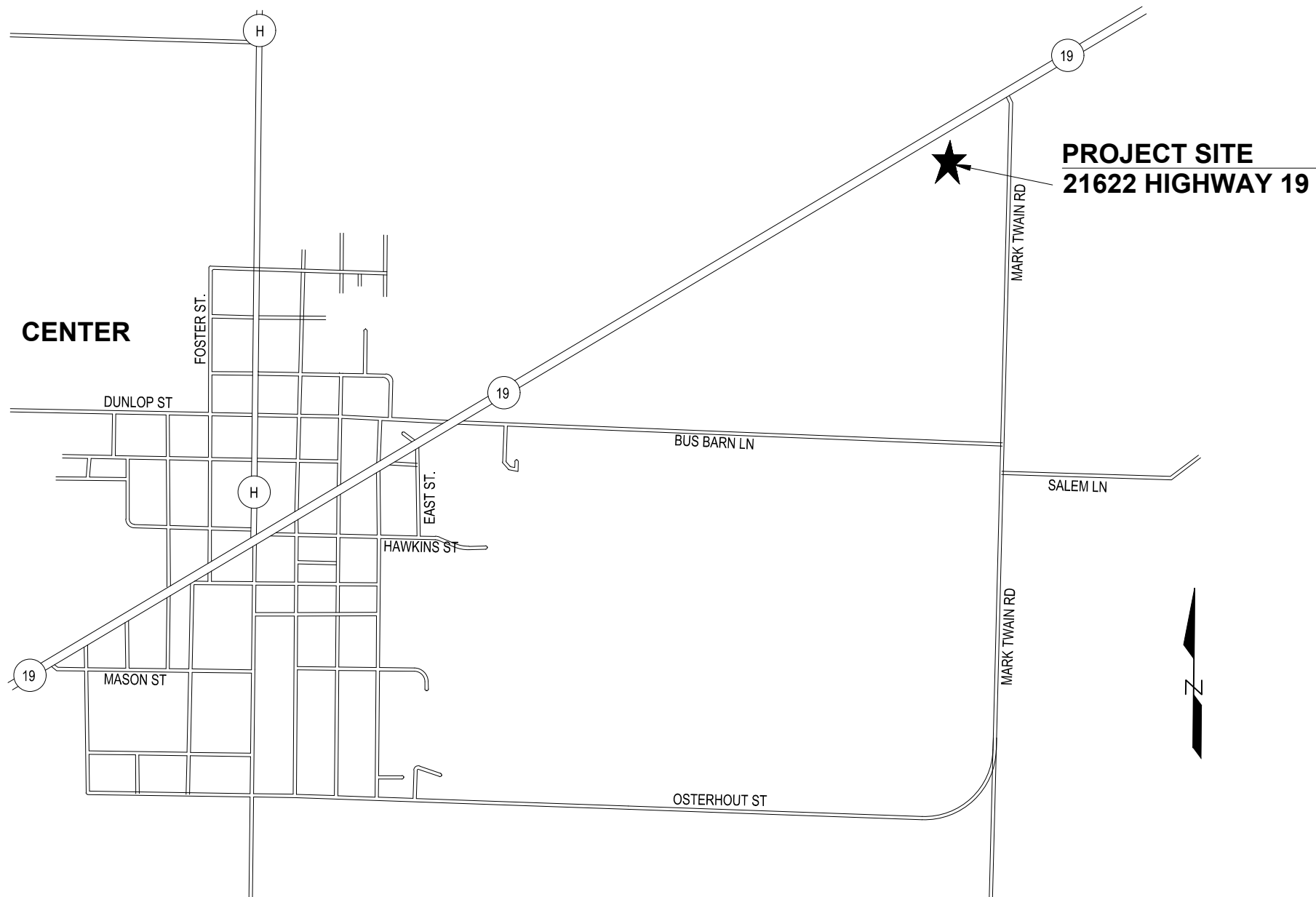

ARCHITECT OF RECORD:



CONTACT PERSON: JACQUES REYNOLDS, AIA  
PROJECT NO.  
STATE OF MISSOURI  
ENGINEERING CORPORATION  
LICENSE NO. 2014009673

CIVIL ENGINEER:

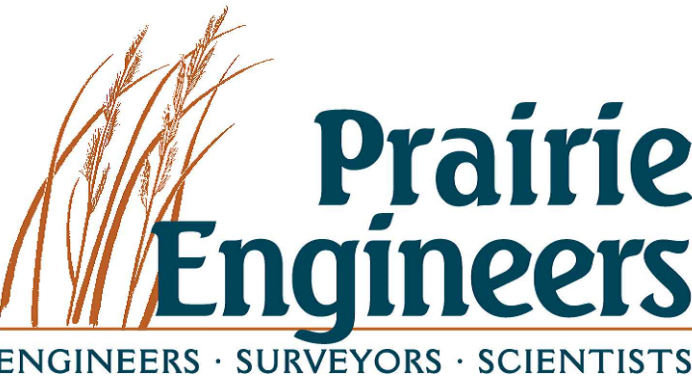

CONTACT PERSON: NATHEN E. LEACH, P.E.  
PROJECT NO. 280.2001  
STATE OF MISSOURI  
ENGINEERING CORPORATION  
LICENSE NO. 2016036823

CIVIL ENGINEER

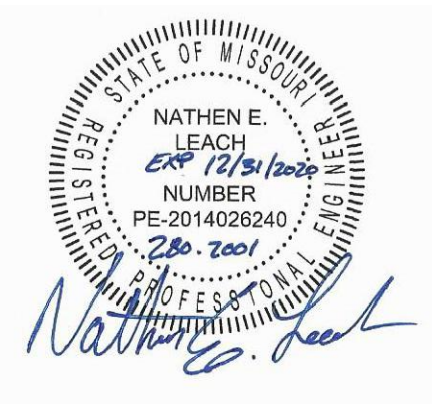

NATHEN E. LEACH, P.E.  
LICENSED PROFESSIONAL ENGINEER  
STATE OF MISSOURI LICENSE NO. 2014026240  
LICENSE EXPIRES: 12/31/2020  
PRAIRIE ENGINEERS  
THIS SEAL COVERS: G001-C504

ELECTRICAL ENGINEER



MATTHEW FULLER, P.E.  
LICENSED PROFESSIONAL ENGINEER  
STATE OF MISSOURI LICENSE NO. 2015006513  
LICENSE EXPIRES: 12/31/2021  
PRAIRIE ENGINEERS  
THIS SEAL COVERS: E101-E301

### INDEX OF SHEETS

G001	COVER SHEET
G101	GENERAL NOTES
C100	EXISTING CONDITIONS & DEMOLITION PLAN
C101	SITE PLAN (PARKING LOT)
C102	SITE PLAN (ENTRANCES)
C103	GRADING, DRAINAGE & EROSION CONTROL PLAN (PARKING LOT)
C104	GRADING, DRAINAGE & EROSION CONTROL PLAN (ENTRANCES)
C501-C504	SITE DETAILS
E101	GENERAL NOTES
E201	LIGHTING SITE PLAN
E301	LIGHTING DETAILS

APR 22, 2020 2:34 PM NLEACH  
I:\JOBS\2020\280.2001 - RALLS COUNTY SCHOOL PARKING LOT & BASEBALL FIELD\DRAWINGS\280.2001\_G001.DWG

**Prairie Engineers, P.C.**  
106 Washington St.  
Keokuk, IA 52632  
(217) 605-0403  
www.prairieengineers.com  
Engineering Corporation No.: 2016036823  
©Copyright Prairie Engineers, P.C. 2020



DRAWING DATE	04/24/2020	REVISION 1	
DESIGNED BY	NEL	04/20/20	BY & DATE
DRAWN BY	JLM	04/20/20	REVISION 2
CHECKED BY	JHL	04/23/20	BY & DATE

COVER SHEET  
RALLS COUNTY R-II SCHOOL DISTRICT  
21622 HIGHWAY 19  
CENTER, MISSOURI 63436

PEI PROJECT NO.	280.2001
PROJECT NAME	RALLS COUNTY R-II PARKING EXPANSION
FILENAME	280.2001_G001.dwg
DRAWING SCALE	N/A

G001

\_1\_ of \_14\_ sheets



APR 22, 2020 3:02 PM NLEACH  
I:\JOBS\2020\280.2001\_RALLS COUNTY SCHOOL PARKING LOT & BASEBALL FIELD\DRAWINGS\280.2001\_GENERAL NOTES.DWG

GENERAL NOTES:

1. PLAN DIMENSIONS AND DETAILS RELATIVE TO PLANS AND DETAILS ARE SUBJECT TO NOMINAL CONSTRUCTION VARIATIONS. THE CONTRACTOR SHALL VERIFY ALL DIMENSIONS. DISCREPANCIES IN THE PLANS AND OR FIELD DIMENSIONS AFFECTING CONSTRUCTION SHALL BE BROUGHT TO THE ATTENTION OF THE ENGINEER PRIOR TO PROCEEDING WITH CONSTRUCTION.
2. ANY DISCREPANCIES BETWEEN SPECIFICATIONS, DRAWINGS AND/OR SITE CONDITIONS SHALL BE REPORTED TO THE ENGINEER IMMEDIATELY.
3. ALL AREAS DESIGNATED TO REMAIN UNDISTURBED SHALL BE PROTECTED BY THE CONTRACTOR THROUGHOUT CONSTRUCTION.
4. THE CONTRACTOR SHALL BE RESPONSIBLE FOR STAKING THE LOCATION OF ALL PROPOSED IMPROVEMENTS, INCLUDING ROUGH AND FINISHED ELEVATIONS AND ALL OTHER PROPOSED IMPROVEMENTS INDICATED ON THE DRAWINGS.
5. THE CONTRACTOR SHALL VERIFY THAT ALL APPLICABLE LOCAL, STATE, AND FEDERAL CODES ARE FOLLOWED. ALL APPLICABLE LOCAL AND STATE NOTIFICATIONS AND PERMITS SHALL BE ACQUIRED PRIOR TO CONSTRUCTION.
6. THE CONTRACTOR SHALL BE RESPONSIBLE FOR MAINTAINING ALL REFERENCE POINTS, BENCHMARKS, MONUMENTS, STAKES, AND PROPERTY CORNERS DURING CONSTRUCTION. REPLACEMENT OF LOST REFERENCE POINTS SHALL BE PERFORMED BY A LICENSED PROFESSIONAL LAND SURVEYOR IN THE STATE OF MISSOURI, AND WILL BE AT THE CONTRACTORS EXPENSE.
7. REMOVE ALL STRUCTURES, FOUNDATIONS, PAVEMENTS, AND ALL OTHER ITEMS IN CONFLICT WITH THE PROPOSED IMPROVEMENTS IN ACCORDANCE WITH THE SPECIFICATIONS.
8. REFERENCES TO "STANDARD SPECIFICATIONS" SHALL MEAN THE MISSOURI DEPARTMENT OF TRANSPORTATION, "MISSOURI STANDARD SPECIFICATIONS FOR HIGHWAY CONSTRUCTION", LATEST EDITION.
9. NO WORK SHALL BE PERFORMED BEYOND THE LIMITS OF CONSTRUCTION WITHOUT OWNER / ENGINEER APPROVAL.
10. SITE CLEAN-UP SHALL BE PERFORMED ON A DAILY BASIS. ROADWAYS, AND THE PROJECT SITE SHALL BE KEPT CLEAN AT ALL TIMES.
11. ALL OPEN EXCAVATIONS SHALL BE PROTECTED.
12. MAINTAIN POSITIVE DRAINAGE ON THE SITE THROUGHOUT THE PROJECT DURATION.
13. IF A DISCREPANCY IN THE SPOT ELEVATIONS IS NOTED, THE CONTRACTOR SHALL NOTIFY THE ENGINEER PRIOR TO CONSTRUCTING. IF THERE IS A DISCREPANCY BETWEEN THE SPOT ELEVATIONS AND THE CONTOURS, THE CONTOURS SHALL GOVERN.
18. ALL WORK FOR THIS PROJECT DESIGNATED TO TAKE PLACE WITHIN PUBLIC RIGHT OF WAY SHALL BE IN ACCORDANCE WITH STANDARD TRAFFIC CONTROL PROCEDURES OUTLINED BY MODOT. THE CONTRACTOR SHALL BE RESPONSIBLE FOR CLEARLY SIGNING WORK ZONE ENTRANCES AND EXITS, AND IMPLEMENTING AND MAINTENANCE OF TRAFFIC CONTROL WITH IN RIGHT-OF-WAY.
19. THE CONTRACTOR SHALL COORDINATE ACCEPTABLE HAUL ROADS / SITE ACCESS WITH ENGINEER AND LOCAL PUBLIC AGENCY. CONTRACTOR WILL BE RESPONSIBLE FOR MAINTENANCE OF ACCESS ROADS DETERIORATED BY CONSTRUCTION TRAFFIC.
20. ALL ELEVATIONS SHOWN REFER TO AU.S.G.S.MEAN SEA LEVEL DATUM (NAVD 1988)

DEMOLITION NOTES

1. CONTRACTOR SHALL REMOVE ALL WASTE OR UNDESIRABLE MATERIAL AS IDENTIFIED BY THE ENGINEER. WASTE SHALL BE DISPOSED OF OUTSIDE THE LIMITS OF THE PROJECT AT THE CONTRACTORS EXPENSE.
2. CONTRACTOR SHALL BE RESPONSIBLE FOR ALL PERMIT AND DISPOSAL FEES.
3. THE REMOVAL OF EXISTING ROADWAY, ROADWAY STRUCTURES, PAVEMENTS, CULVERTS, FENCE, AND RELATED ITEMS SHALL BE INCLUDED IN THE COST OF THE LUMP SUM CONTRACT AND NO ADDITIONAL COMPENSATION WILL BE ALLOWED.

GRADING NOTES

1. TOPSOIL SHALL BE STRIPPED TO A DEPTH OF ±7 INCHES WITHIN ALL PROPOSED PAVEMENT AREAS AND STOCKPILED ON SITE FOR FUTURE USE. CONTRACTOR SHALL COORDINATE STOCK PILE AREA WITH OWNER. AREAS INTENDED TO BE SEEDED SHALL HAVE TOPSOIL PLACED TO A DEPTH OF 6 INCHES (FROM STOCK PILES). EXCESS TOPSOIL SHALL BE DISPOSED OF AT AN APPROVED LOCATION AT THE EXPENSE OF THE CONTRACTOR.
2. TOPSOIL SHALL BE LOAMY IN NATURE. TOPSOIL SHALL BE FREE FROM HARD CLODS, STIFF CLAY, SOD, STONES, ROOTS, STICKS AND OTHER UNDESIRABLE DEBRIS OVER 1 INCH. TOPSOIL SHALL BE FREE FROM TOXIC MATERIALS AND SHALL HAVE A pH RANGE BETWEEN 5.5 AND 7.0.
3. A GEOTECHNICAL REPORT HAS BEEN PREPARED FOR THIS SITE BY THE OWNER AND IS AVAILABLE UPON REQUEST.
4. STRUCTURAL AND BACKFILL MATERIAL SHALL BE PLACED IN ACCORDANCE WITH THE STANDARD SPECIFICATIONS. FILL SHOULD BE PLACED IN MAXIMUM 8 INCH LIFTS AND COMPACTED TO THE SPECIFIED PERCENT OF THE DRY DENSITY AS DETERMINED ACCORDING TO AASHTO T 99 (METHOD C).
5. SUBGRADES FOR SITE ROADS SHALL BE DEFINED AS THE TOP 12 INCHES. SUBGRADES SHALL BE COMPACTED TO A MINIMUM DRY DENSITY OF 95 PERCENT OF THE STANDARD LABORATORY DENSITY. IN AREAS WHERE THE SUBGRADE IS IN UNDISTURBED AREAS THE SUBGRADE OR TOP 12 INCHES SHALL BE DISKED AND RECOMPACTED TO THE SPECIFIED LABORATORY DRY DENSITY.
6. TEMPORARY EXCAVATIONS SHALL BE CONSTRUCTED IN ACCORDANCE WITH OSHA REGULATIONS. SHALLOW EXCAVATIONS EXTENDING INTO THESE SOILS SHOULD BE CUT ON A SLOPE NO STEEPER THAN 2H:1V. EXCAVATION DEEPER THAN 20 FEET MUST BE DESIGNED BY A REGISTERED PROFESSIONAL ENGINEER.
7. ALL EXCESS MATERIALS NOT USED FOR CONSTRUCTION OF THE PROJECT SHALL BE DISPOSED OFF SITE BY THE CONTRACTOR AT THE CONTRACTORS EXPENSE.
8. PROPOSED CONTOURS ARE INTENDED TO PROVIDE A MINIMUM 0.5% SLOPE ON PAVEMENTS AND 1.0% ELSEWHERE. THE CONTRACTOR SHALL BE RESPONSIBLE FOR PROVIDING A SMOOTH UNIFORM DRAINING SURFACE THAT DOES NOT CREATE PONDING WATER OR SHARP BREAKS. CONTOURS OR ELEVATION THAT WILL NOT PROVIDE SUCH A SURFACE SHALL BE BROUGHT TO THE ATTENTION OF THE ENGINEER IMMEDIATELY.
9. IF SOIL OR GROUNDWATER IS ENCOUNTERED WHICH EMITS A PETROLEUM ODOR OR IS DISCOLORED, THE CONTRACTOR SHALL STOP EXCAVATION AND NOTIFY THE OWNER IMMEDIATELY. THE OWNER WILL COORDINATE ENVIRONMENTAL EFFORTS TO HANDLE THE IMPACTED SOIL OR GROUNDWATER IN ACCORDANCE WITH FEDERAL, STATE, AND LOCAL REQUIREMENTS. THE CONTRACTOR SHALL TAKE APPROPRIATE ACTION TO ENSURE PUBLIC AND EMPLOYEE SAFETY.
10. SLOPES STEEPER THAT 4:1 (H:V) SHALL RECEIVE A TEMPORARY EROSION CONTROL MAT PROVIDING PROTECTION FOR UP TO 12 MONTHS OR UNTIL PERMANENT EROSION CONTROL MEASURES ARE IMPLEMENTED.
11. ALL DISTURBED AREAS OUTSIDE OF PAVEMENT AND OR RIPRAP SHALL BE SEEDED PER THE STANDARD SPECIFICATIONS. AREAS INDICATED ON THE PLANS ARE ESTIMATED DISTURBED AREAS. ALL DISTURBED AREAS SHALL BE SEEDED REGARDLESS OF THE AREA SHOWN.

EROSION CONTROL NOTES

1. EROSION CONTROL SHALL BE INSTALLED IN ACCORDANCE WITH MANUFACTURER'S RECOMMENDATIONS, THE DETAILS IN THESE PLANS, AND THE MISSOURI DEPARTMENT OF NATURAL RESOURCES.
2. THE EROSION CONTROL SHOWN ON THIS SET OF PLANS SHALL BE CONSIDERED THE MINIMUM ACCEPTABLE FOR THIS PROJECT. THERE MAY BE ADDITIONAL EROSION CONTROL REQUIRED DUE TO THE VARIOUS CONSTRUCTION TECHNIQUES, WHICH MAY BE USED. THE CONTRACTOR IS RESPONSIBLE FOR CONTROLLING AND MAINTAINING ALL THE RUNOFF FROM THE SITE, IN A MANNER WHICH KEEPS ALL SILT ON SITE.
3. A LAND DISTURBANCE PERMIT IS REQUIRED SINCE MORE THAN 1 ACRE OF LAND WILL BE DISTURBED BY GRADING OPERATIONS ( SEE STORM WATER PLAN NOTES). THE CONTRACTOR WILL BE RESPONSIBLE FOR USE AND MAINTENANCE OF BEST PRACTICE METHODS TO CONTROL SEDIMENT / EROSION.

PAVEMENT NOTES

1. PAVEMENT REFERENCES SHALL BE IN ACCORDANCE WITH THE MISSOURI DEPARTMENT OF TRANSPORTATION STANDARD SPECIFICATIONS, LATEST EDITION.
2. PROOF-ROLL SUBGRADE WITH A MINIMUM 25 TON G.V.W. TRUCK TO IDENTIFY AREAS OF SOFT OR UNSTABLE SUBGRADE. PERMANENT RUTTING IN EXCESS OF 1 INCH SHALL BE CONSIDERED FAILURE. ELASTIC MOVEMENT IN EXCESS OF 1 INCH WITH SUBSTANTIAL CRACKING OR SUBSTANTIAL LATERAL MOVEMENT SHALL BE CONSIDERED FAILURE. REMOVE AND REPLACE UNSTABLE AREAS WITH SUITABLE COMPACTED MATERIALS.
3. ALL DIMENSIONS ARE TO BACK OF CURB, EDGE OF PAVEMENT, EDGE OF BUILDING, OR PROPERTY LINES UNLESS OTHERWISE NOTED. ALL RADII ARE TO BACK OF CURB IF NO CURB EXITS THEN DIMENSION ARE TO EDGE OF PAVEMENT.

UTILITY NOTES

1. THE LOCATIONS OF BURIED AND ABOVE GROUND UTILITIES SHOWN ARE APPROXIMATE, ARE SHOWN FOR CONTRACTORS INFORMATIONAL USE ONLY, AND ARE NOT TO BE REFERENCED FOR CONSTRUCTION PURPOSES. THE IMPLIED PRESENCE OR ABSENCE OF UTILITIES IS NOT TO BE CONSTRUED BY THE GOVERNMENT, ENGINEER, CONTRACTOR, OR SUBCONTRACTORS TO BE AN ACCURATE AND COMPLETE REPRESENTATION OF UTILITIES THAT MAY OR MAY NOT EXIST ON THE CONSTRUCTION SITE. BURIED AND ABOVEGROUND UTILITY LOCATION, IDENTIFICATION AND MARKING ARE THE SOLE RESPONSIBILITY OF THE CONTRACTOR. REROUTING, DISCONNECTION, PROTECTION, ETC OF ANY UTILITIES MUST BE COORDINATED BETWEEN THE CONTRACTOR, UTILITY COMPANY, AND THE GOVERNMENT. SITE SAFETY, INCLUDING THE AVOIDANCE OF HAZARDS ASSOCIATED WITH BURIED AND ABOVEGROUND UTILITIES REMAIN THE SOLE RESPONSIBILITY OF THE CONTRACTOR.
2. THE DRAWINGS INDICATE THE BEST KNOWLEDGE OF THE OWNER AND ENGINEER ON THE GENERAL LOCATION AND NATURE OF THE EXISTING AND OR PROPOSED UNDERGROUND UTILITIES IN THE AREA OF CONSTRUCTION. A UTILITY LOCATE WAS REQUESTED FOR AREAS ALONG RIGHT-OF-WAY FOR THIS SITE. REGARDLESS OF THE LEVEL OF INVESTIGATION, THE UTILITIES SHOWN SHOULD NOT BE CONSIDERED A WARRANTY OR GUARANTEE OF ACTUAL PRESENCE OR LOCATION AND THE CONTRACTOR REMAINS RESPONSIBLE FOR THE LOCATION, VERIFICATION, AND PROPER NOTIFICATION OF POTENTIAL UTILITIES.

BIDDING INFORMATION

1. BASE BID - PARKING LOT IMPROVEMENTS: THIS WORK SHALL INCLUDE BUT NOT BE LIMITED TO ALL WORK, MATERIALS, LABOR AND EQUIPMENT TO BUILD 51 PARKING STALLS AND ASSOCIATED DRIVE LANES, SIDEWALKS CONNECTING TO BOTH THE ELEMENTARY SCHOOL AND JUNIOR HIGH SCHOOL, PAVEMENT MARKING ASSOCIATED WITH THE PARKING LOT AND DRIVE LANE AND SITE LIGHTING. WORK SHALL ALSO INCLUDE ALL GRADING, CONCRETE PAVEMENT, BASE ROCK, TIE BARS, DRAINAGE STRUCTURES, LIGHTING AND SEEDING/LANDSCAPING. NEW CONCRETE PAVEMENTS SHALL BE TIED TO THE EXISTING PAVEMENT WITH ¾" DOWEL BARS AT 18" SPACING. THE CONTRACTOR WILL BE RESPONSIBLE FOR OBTAINING AND COMPLYING WITH NECESSARY PERMITTING TO COMPLETE THE PROJECT.
2. ALTERNATE BID #1 - ENTRANCE RE-CONFIGURATION: THIS WORK SHALL CONSIST OF BUT NOT BE LIMITED TO ALL WORK, MATERIALS, LABOR AND EQUIPMENT TO RECONFIGURE BOTH THE ELEMENTARY SCHOOL AND JUNIOR HIGH ENTRANCES. WORK ON THE ELEMENTARY SCHOOL ENTRANCE SHALL CONSIST OF PAVEMENT MARKING AS SHOWN ON THE PLANS TO RECONFIGURE THE ENTRANCE TO ONE LANE. THIS SHALL ALSO INCLUDE PAVEMENT MARKING (DIRECTIONAL) ARROWS AND MARKINGS SHOWN AT THE NEW ENTRANCE TO THE PARKING LOT ADDITION. WORK ON THE JUNIOR HIGH ENTRANCE SHALL INCLUDE ALL REMOVALS, GRADING, CONCRETE PAVEMENT, BASE ROCK, TIE BARS, DRAINAGE STRUCTURES, SEEDING AND LANDSCAPING TO RECONFIGURE THE ENTRANCE AS SHOWN ON THE PLANS. NEW PAVEMENTS SHALL BE TIED TO EXISTING PAVEMENT WITH ¾" DOWEL BARS AT 18" SPACING. THIS WORK WILL ALSO INCLUDE AN ADDITIONAL THREE (3) PARKING STALLS IN THE NEW PARKING LOT, AND NEW PAVEMENT NEAR THE EXISTING PARKING LOT. THIS WILL REQUIRE WORK ON OR NEAR STATE HIGHWAY 19 RIGHT-OF-WAY THAT WILL REQUIRE COORDINATION WITH THE MISSOURI DEPARTMENT OF TRANSPORTATION (MODOT). THE CONTRACTOR WILL BE RESPONSIBLE FOR OBTAINING NECESSARY PERMITTING AND COMPLYING WITH ALL MODOT REQUIREMENTS FOR TRAFFIC CONTROL AND PROTECTION.
3. ALTERNATE BID #2 - ADDITIONAL PARKING EXPANSION: THIS WORK SHALL INCLUDE BUT NOT BE LIMITED TO ALL WORK, MATERIALS, LABOR AND EQUIPMENT TO BUILD 14 PARKING STALLS ALONG THE EXISTING ELEMENTARY SCHOOL BUS ACCESS DRIVE. WORK SHALL INCLUDE GRADING, CONCRETE PAVEMENT, BASE ROCK, DRAINAGE STRUCTURES, LIGHTING, SEEDING AND LANDSCAPING TO COMPLETE AS SHOWN ON THE PLAN. CONCRETE PAVEMENT SHALL BE TIED WITH ¾" DOWEL BARS AT 18" SPACING TO THE EXISTING CONCRETE PAVEMENT. EXISTING LIGHT POLE SHALL BE RELOCATED AS TO NOT INTERFERE WITH CURRENT AND FUTURE PARKING STALLS.

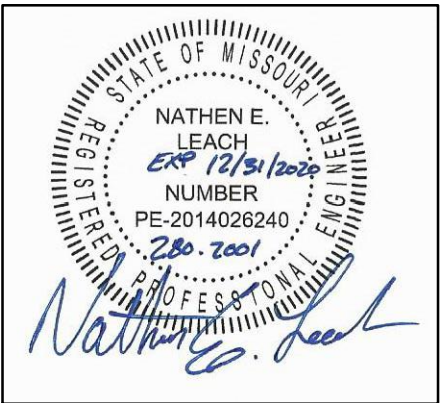

LEGEND

EXISTING	PROPOSED	
		FD. MONUMENT AS NOTED
		SET 5/8" REBAR W/ CAP
		FLOOD ZONE
		PROPERTY LINE
		LOT LINE
		RIGHT OF WAY LINE
		CENTERLINE
		EASEMENT
		BUILDING SETBACK
		EDGE OF PAVEMENT
		WATER LINE
		GAS LINE
		OVERHEAD ELECTRIC
		UNDERGROUND ELECTRIC
		FIBER OPTIC
		COMMUNICATION LINE
		STORM SEWER
		SANITARY SEWER
		SIGN
		UTILITY POLE
		LIGHT POLE
		CONTOURS
		INDEX CONTOURS
		DIRECTION OF DRAINAGE
		SPOT ELEVATION
		TREE

UTILITY/EMERGENCY INFORMATION

MISSOURI ONE CALL -- 811 OR 1-800-344-7483

WATER

CLARENCE CANNON WWC  
34146 ROUTE U  
STOUTSVILLE, MO 65283  
GENERAL (573)-672-3221

ELECTRIC & GAS

AMEREN MISSOURI (GAS)  
P.O. BOX 790098  
ST. LOUIS, MO 63179-0098  
GENERAL (866)-992-6619

DATA

MNA BLUEBIRD  
2005 W. BROADWAY,  
BLDG A SUITE 215  
COLUMBIA, MO 65203  
1-877-766-2662

RALLS COUNTY ELECTRICAL CO-OP

17594 HIGHWAY 19  
NEW LONDON, MO 63459  
1-877-985-8711  
(573) 985-8711

AT&T DISTRIBUTION

HANNIBAL REGIONAL HOSPITAL  
6000 HOSPITAL DRIVE  
HANNIBAL, MO. 63401  
(573) 248-1300

EMERGENCY -- DIAL 911

POLICE -- (573) 267-3770  
FIRE -- (573) 267-3333

DRAWING DATE	04/24/2020	REVISION 1	
DESIGNED BY	NEL 04/20/20	BY & DATE	
DRAWN BY	JLM 04/20/20	REVISION 2	
CHECKED BY	JHL 04/23/20	BY & DATE	

PEI PROJECT NO.	280.2001
PROJECT NAME	RALLS COUNTY R-II PARKING EXPANSION
FILENAME	280.2001_General Notes.dwg
DRAWING SCALE	NOTED



APR 22, 2020 3:12 PM NLEACH  
I:\JOBS\2020\280.2001 RALLS COUNTY SCHOOL PARKING LOT & BASEBALL FIELD\DRAWINGS\280.2001\_DEMOLITION PLAN.DWG

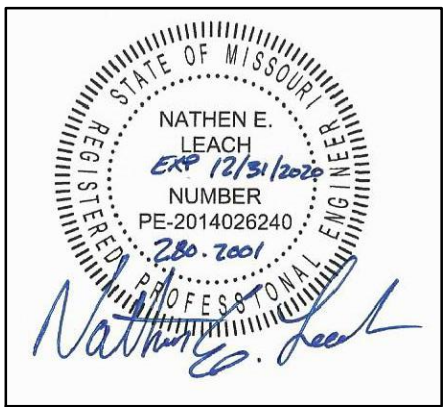
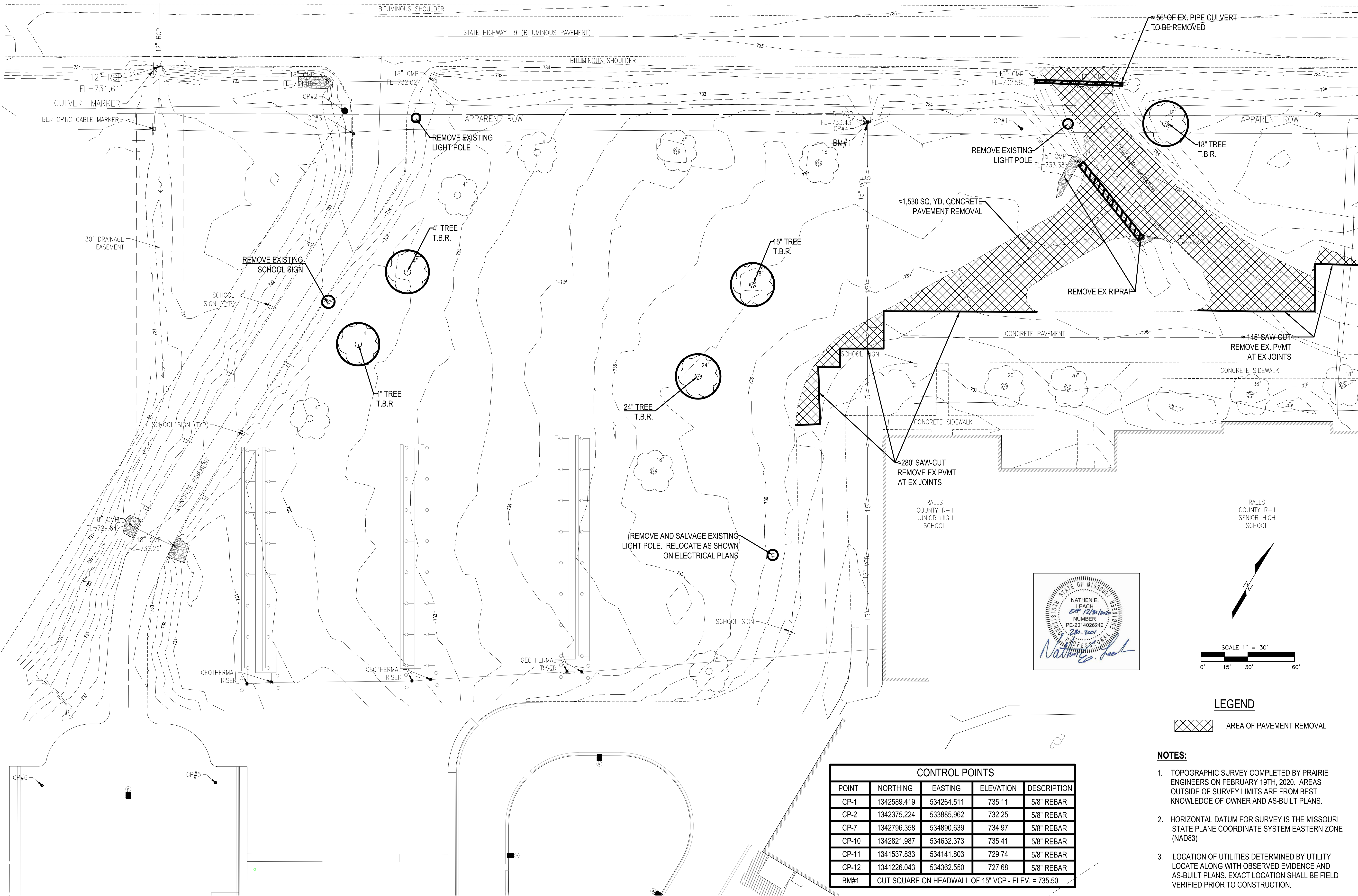

LEGEND

AREA OF PAVEMENT REMOVAL

NOTES:

- TOPOGRAPHIC SURVEY COMPLETED BY PRAIRIE ENGINEERS ON FEBRUARY 19TH, 2020. AREAS OUTSIDE OF SURVEY LIMITS ARE FROM BEST KNOWLEDGE OF OWNER AND AS-BUILT PLANS.
- HORIZONTAL DATUM FOR SURVEY IS THE MISSOURI STATE PLANE COORDINATE SYSTEM EASTERN ZONE (NAD83)
- LOCATION OF UTILITIES DETERMINED BY UTILITY LOCATE ALONG WITH OBSERVED EVIDENCE AND AS-BUILT PLANS. EXACT LOCATION SHALL BE FIELD VERIFIED PRIOR TO CONSTRUCTION.

CONTROL POINTS				
POINT	NORTHING	EASTING	ELEVATION	DESCRIPTION
CP-1	1342589.419	534264.511	735.11	5/8" REBAR
CP-2	1342375.224	533885.962	732.25	5/8" REBAR
CP-7	1342796.358	534890.639	734.97	5/8" REBAR
CP-10	1342821.987	534632.373	735.41	5/8" REBAR
CP-11	1341537.833	534141.803	729.74	5/8" REBAR
CP-12	1341226.043	534362.550	727.68	5/8" REBAR
BM#1	CUT SQUARE ON HEADWALL OF 15" VCP - ELEV. = 735.50			

**Prairie Engineers, P.C.**  
106 Washington St.  
Keokuk, IA 52632  
(217) 605-0403

[www.prairieengineers.com](http://www.prairieengineers.com)  
Engineering Corporation No.: 2016036823  
©Copyright Prairie Engineers, P.C. 2020

**Prairie Engineers**  
ENGINEERS • SURVEYORS • SCIENTISTS

DRAWING DATE	04/24/2020	REVISION 1	
DESIGNED BY	NEL 04/20/20	BY & DATE	
DRAWN BY	JLM 04/20/20	REVISION 2	
CHECKED BY	JHL 04/23/20	BY & DATE	

EXISTING CONDITIONS & DEMOLITION PLAN  
RALLS COUNTY R-II SCHOOL DISTRICT  
21622 HIGHWAY 19  
CENTER, MISSOURI 63436

PEI PROJECT NO.	280.2001
PROJECT NAME	RALLS COUNTY R-II PARKING EXPANSION
FILENAME	280.2001_Demolition Plan.dwg
DRAWING SCALE	NOTED

C100

\_3\_ of \_14\_ sheets







(X) COORDINATE POINT TABLE		
POINT	NORTHING	EASTING
100	1342431.76	533924.58
101	1342390.64	533914.34
102	1342380.47	533920.44
103	1342353.45	533927.54
104	1342294.18	533926.00
105	1342289.05	533930.86
106	1342288.86	533937.96
107	1342361.56	533938.93
108	1342372.09	533933.99
109	1342390.99	533922.77
110	1342401.19	533918.62
111	1342414.15	533917.02
112	1342422.50	533917.46
113	1342426.95	533918.75

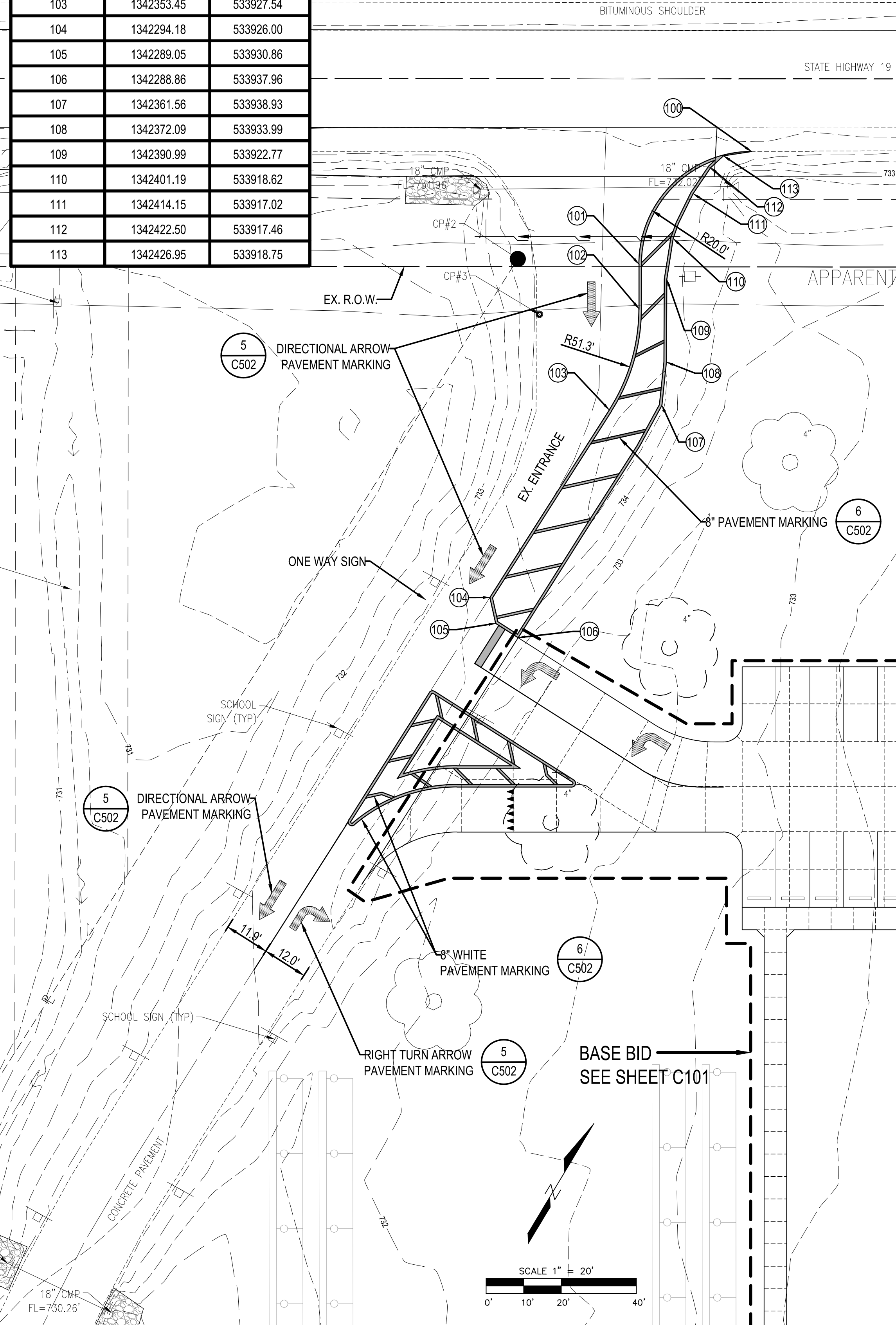

<div style="display: flex; align-items: center;"> <div style="border: 1px solid black; border-radius: 50%; width: 30px; height: 30px; display: flex; align-items: center; justify-content: center; margin-right: 10px;">X</div> <div>COORDINATE POINT TABLE</div> </div>		
POINT	NORTHING	EASTING
1	1342493.02	534331.68
2	1342541.02	534411.60
3	1342546.56	534362.51
4	1342618.48	534319.38
5	1342673.00	534332.55
6	1342628.77	534261.51
7	1342622.08	534289.24
8	1342534.16	534341.96
9	1342570.37	534460.46
10	1342585.82	534486.18
11	1342611.54	534470.73

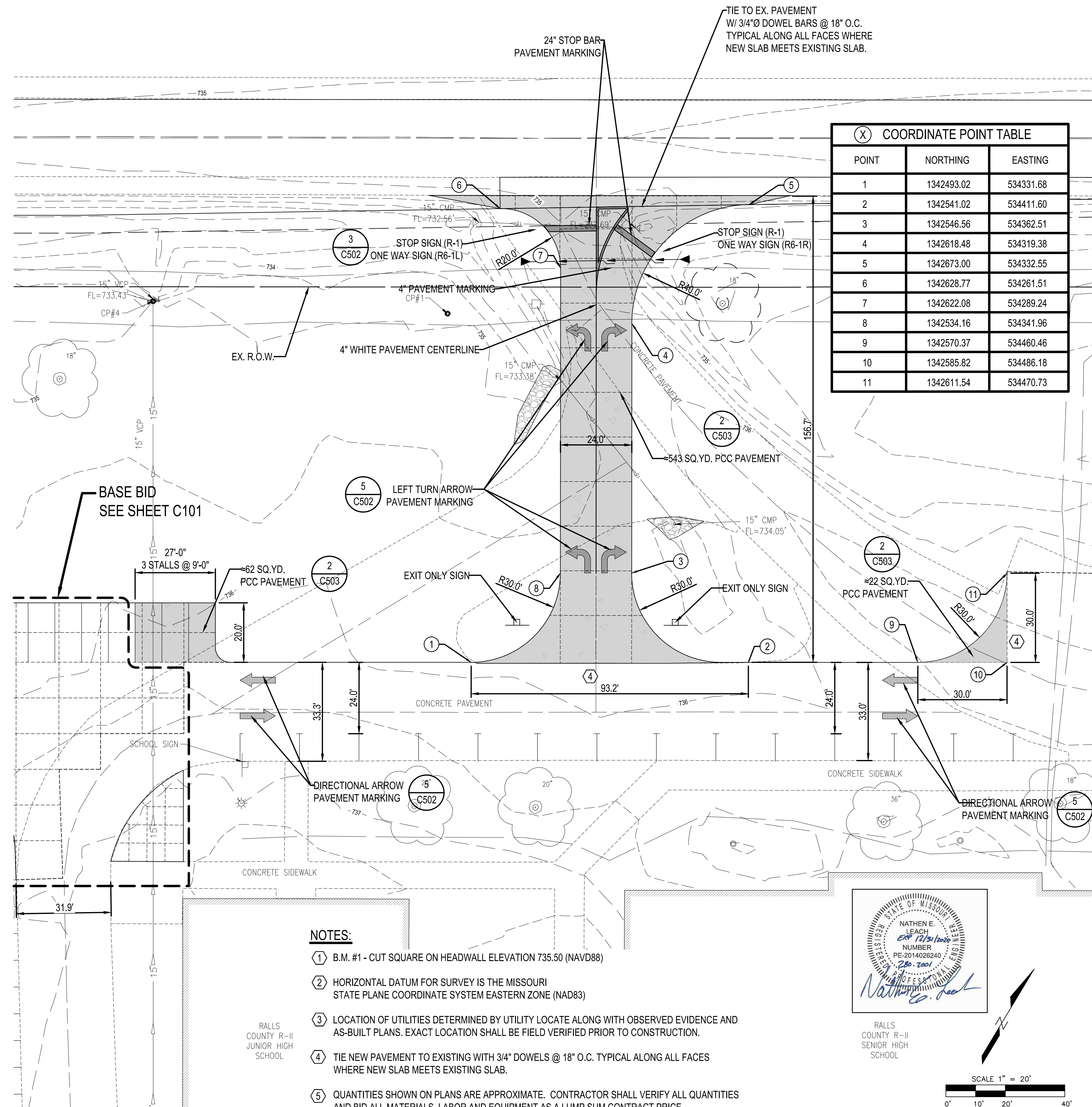

NOTES:

- ① B.M. #1 - CUT SQUARE ON HEADWALL ELEVATION 735.50 (NAVD88)
- ② HORIZONTAL DATUM FOR SURVEY IS THE MISSOURI STATE PLANE COORDINATE SYSTEM EASTERN ZONE (NAD83)
- ③ LOCATION OF UTILITIES DETERMINED BY UTILITY LOCATE ALONG WITH OBSERVED EVIDENCE AND AS-BUILT PLANS. EXACT LOCATION SHALL BE FIELD VERIFIED PRIOR TO CONSTRUCTION.
- ④ TIE NEW PAVEMENT TO EXISTING WITH 3/4" DOWELS @ 18" O.C. TYPICAL ALONG ALL FACES WHERE NEW SLAB MEETS EXISTING SLAB.
- ⑤ QUANTITIES SHOWN ON PLANS ARE APPROXIMATE. CONTRACTOR SHALL VERIFY ALL QUANTITIES AND BID ALL MATERIALS, LABOR AND EQUIPMENT AS A LUMP SUM CONTRACT PRICE.

STATE OF MISSOURI  
NATHAN E. LEACH  
EXPIRES 12/31/2009  
NUMBER  
PE-2014026240  
P.E. 2001  
PROFESSIONAL ENGINEER  
REGISTERED

RALLS  
COUNTY R-  
SENIOR HIGH  
SCHOOL

SCALE 1" = 20'



0' 10' 20'

APR 22, 2020 3:19 PM NLEACH  
\\JOBS\2020\280.001 RALLS COUNTY SCHOOL PARKING LOT & BASEBALL FIELD DRAWINGS\ SHEET\280.001 SITE PLAN 2.DWG

**Prairie Engineers, P.C.**  
106 Washington St.  
Keokuk, IA 52632  
(217) 605-0403

[www.prairieengineers.com](http://www.prairieengineers.com)  
Engineering Corporation No.: 2016036823  
©Copyright Prairie Engineers, P.C. 2020



DRAWING DATE	04/24/2020		REVISION 1
DESIGNED BY	NEL	04/20/20	BY & DATE
DRAWN BY	JLM	04/20/20	REVISION 2
CHECKED BY	JHL	04/23/20	BY & DATE

SITE PLAN  
RALLS COUNTY R-II SCHOOL DISTRICT  
21622 HIGHWAY 19  
CENTER, MISSOURI 63436

PEI PROJECT NO.	280.2001
PROJECT NAME	RALLS COUNTY R-II PARKING EXPANSION
FILENAME	280.2001_Site Plan_2.dwg
DRAWING SCALE	NOTED



C102

5 of 14 sheets

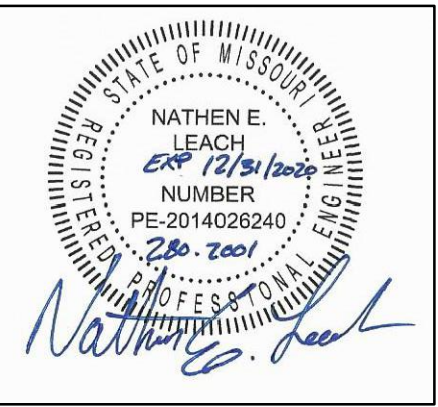



## GRADING NOTES LEGEND

G	GROUND ELEVATION		SWALE
EP	EDGE PAVMT		
TRM	TURF REINF. MAT		TRM
			SUMMIT

1. TOPSOIL SHALL BE STRIPPED WITHIN ALL PROPOSED BUILDING AND PAVEMENT AREAS AND STOCKPILED ON SITE FOR USE IN LANDSCAPE AREAS (COORDINATE WITH OWNER). ACCEPT TOPSOIL IN LANDSCAPED AREAS SHALL BE PROVIDED (FROM STOCKPILE) TO A DEPTH OF 6 INCHES.
2. STRUCTURAL /BACKFILL MATERIAL SHALL BE PLACED IN 6 INCH TO 8 INCH LIFTS AND COMPACTED TO AT LEAST 95% OF THE MAXIMUM DRY DENSITY AS PER ASTM D 698, AND IN ACCORDANCE WITH THE GEOTECHNICAL REVIEW.
3. SUBGRADES FOR SITE ROADS AND PARKING LOTS SHALL BE COMPACTED TO A DEPTH OF AT LEAST 12 INCHES AND TO A MINIMUM DRY DENSITY OF 98% OF THE MAXIMUM DRY DENSITY AS PER ASTM D 698.
4. ALL EXCESS MATERIALS NOT USED FOR CONSTRUCTION OF THE PROJECT SHALL BE DISPOSED OFF SITE BY THE CONTRACTOR AT THE CONTRACTORS EXPENSE .
5. PROPOSED CONTOURS ARE INTENDED TO PROVIDE A MIN. 0.5% SLOPE IN PAVEMENT AREAS AND 1.5% SLOPE IN TURF AREAS. GRADING IN TURF AREAS WITHIN 20' OF THE BUILDING SHALL PROVIDE A MIN. 2% SLOPE AWAY FROM THE BUILDING. CONTRACTORS SHALL BE RESPONSIBLE FOR PROVIDING A SMOOTH UNIFORM DRAINING SURFACE THAT DOES NOT CREATE PONDING WATER OR SHARP BREAKS. CONTOURS OR ELEVATIONS THAT WILL NOT PROVIDE SUCH SURFACE SHALL BE BROUGHT TO THE ATTENTION OF THE ENGINEER/ARCHITECT IMMEDIATELY.
6. INDICATIONS INDICATED ARE FINISHED SURFACE ELEVATIONS, WHETHER GRASS, CONCRETE, PAVEMENT, OR MULCH. THE CONTRACTOR SHALL COORDINATE SUBGRADE ELEVATIONS TO ALLOW FOR PAVEMENT, CONCRETE OR MULCH DEPTHS.
7. ALL AREAS DISTURBED BY GRADING OPERATIONS SHALL BE SEEDED, MULCHED AND MAINTAINED PER SPECIFICATIONS.
8. ALL TRENCHES UNDER PROPOSED PAVEMENTS, SIDEWALKS, STRUCTURES OR UTILITIES SHALL BE BACKFILLED WITH TRENCH BACKFILL AND COMPACTED PER SPECIFICATIONS.
9. ALL SIDEWALKS & ENTRANCES SHALL COMPLY WITH ADA CODES AND HAVE A MAXIMUM 2.0% CROSS SLOPE, AND MAXIMUM 5.0% RUNNING SLOPE. IF GRADING DOES NOT ALLOW FOR THESE MINIMUM STANDARDS TO BE MET THEN THE CONTRACTOR SHALL CEASE WORK AND NOTIFY ENGINEER IMMEDIATELY.



**Prairie Engineers**  
ENGINEERS • SURVEYORS • SCIENTISTS

GRADING, DRAINAGE & EROSION CONTROL PLAN  
RALLS COUNTY R-II SCHOOL DISTRICT  
21622 HIGHWAY 19  
CENTER, MISSOURI 63436

C103





DRAWING DATE	04/24/2020		REVISION 1
DESIGNED BY	NEL	04/20/20	BY & DATE
DRAWN BY	JLM	04/20/20	REVISION 2
CHECKED BY	JHL	04/23/20	BY & DATE

PEI PROJECT NO.	280.2001
PROJECT NAME	RALLS COUNTY R-II PARKING EXPANSION
FILENAME	280.2001_Grading Plan.dwg
DRAWING SCALE	NOTED

7 of 14 sheets

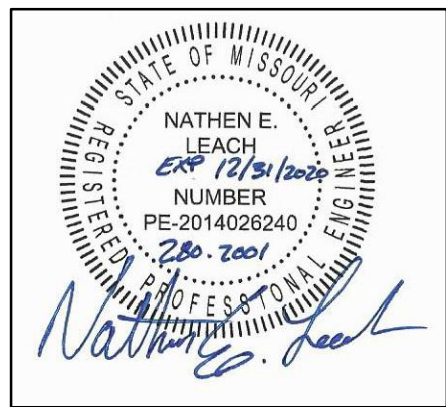



RALLS  
COUNTY R  
SENIOR HI  
SCHOOL

SCALE 1" = 20'

A horizontal graphic scale bar with alternating black and white segments. The segments are labeled 0', 10', 20', and 40' from left to right. The bar is divided into four equal segments, each representing 10 feet. The first segment is black, the second is white, the third is black, and the fourth is white.

## GRADING NOTES LEGEND

G	GROUND ELEVATION		SWALE
EP	EDGE PAVMT		
TRM	TURF REINF. MAT		TRM







APR 22, 2020 3:41 PM NLEACH  
I:\JOBS\2020\280.2001 RALLS COUNTY SCHOOL PARKING LOT & BASEBALL FIELD\DRAWINGS\SHEET\280.2001\_SITE DETAILS.DWG

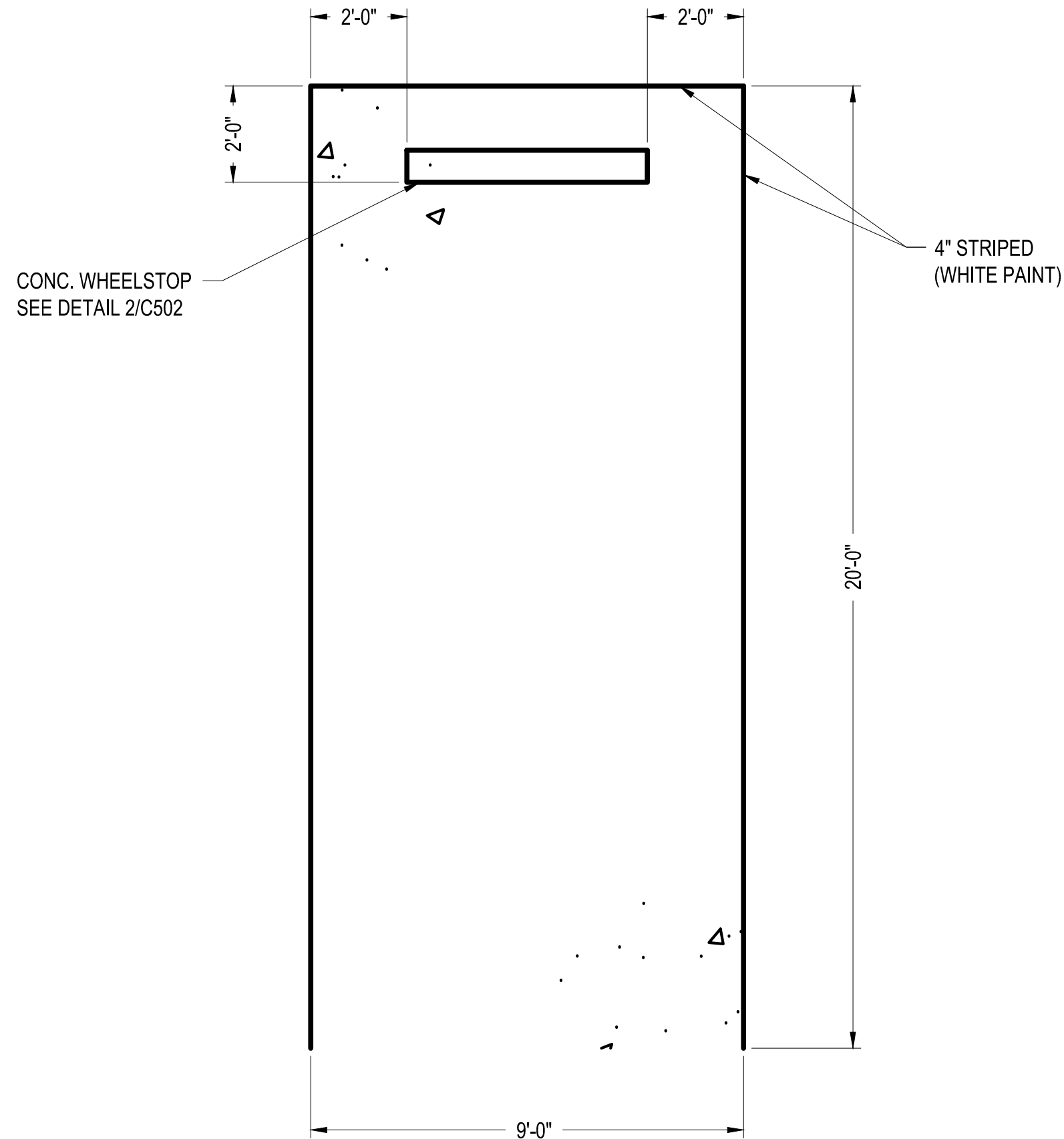

1 STANDARD PARKING STALL LAYOUT  
C502 SCALE: 3/8" = 1'-0"

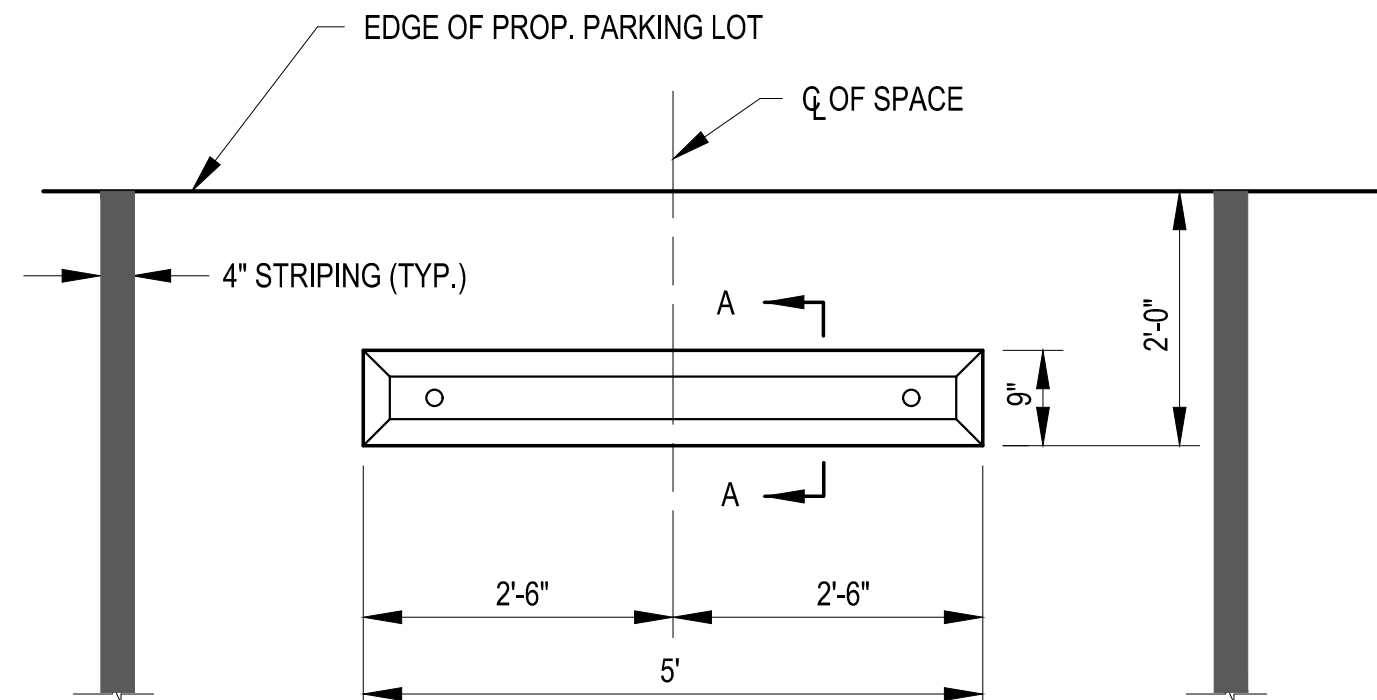

2 WHEEL STOP DETAIL  
C502 SCALE: 3/8" = 1'-0"

Figure 3B-16. Recommended Yield Line Layouts

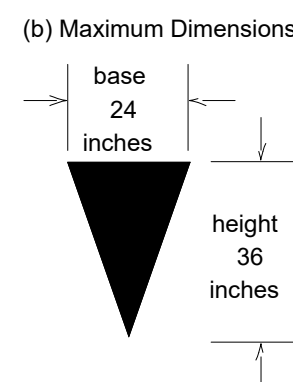
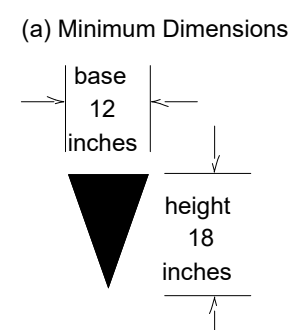
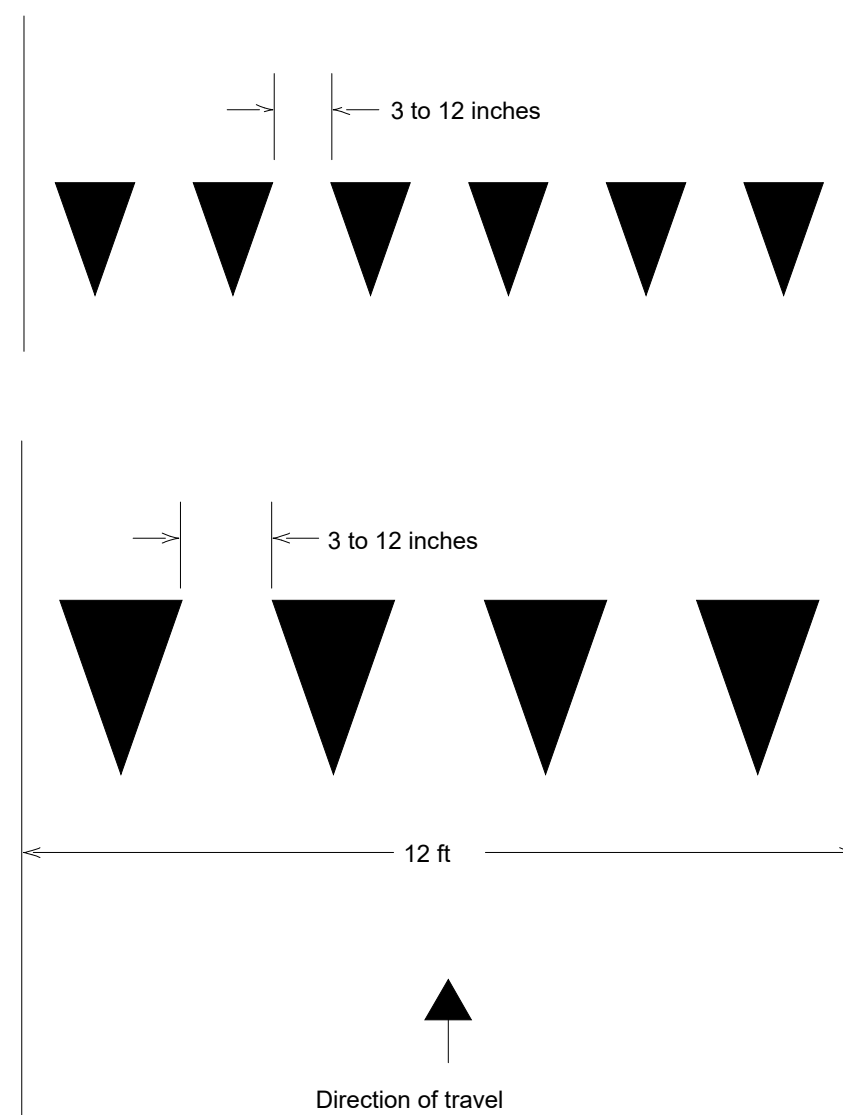

Notes:  
Triangle height is equal to 1.5 times the base dimension.

Yield lines may be smaller than suggested when installed on much narrower, slow-speed facilities such as shared-use paths.

4 YIELD BAR DETAILS  
C502 SCALE: NONE

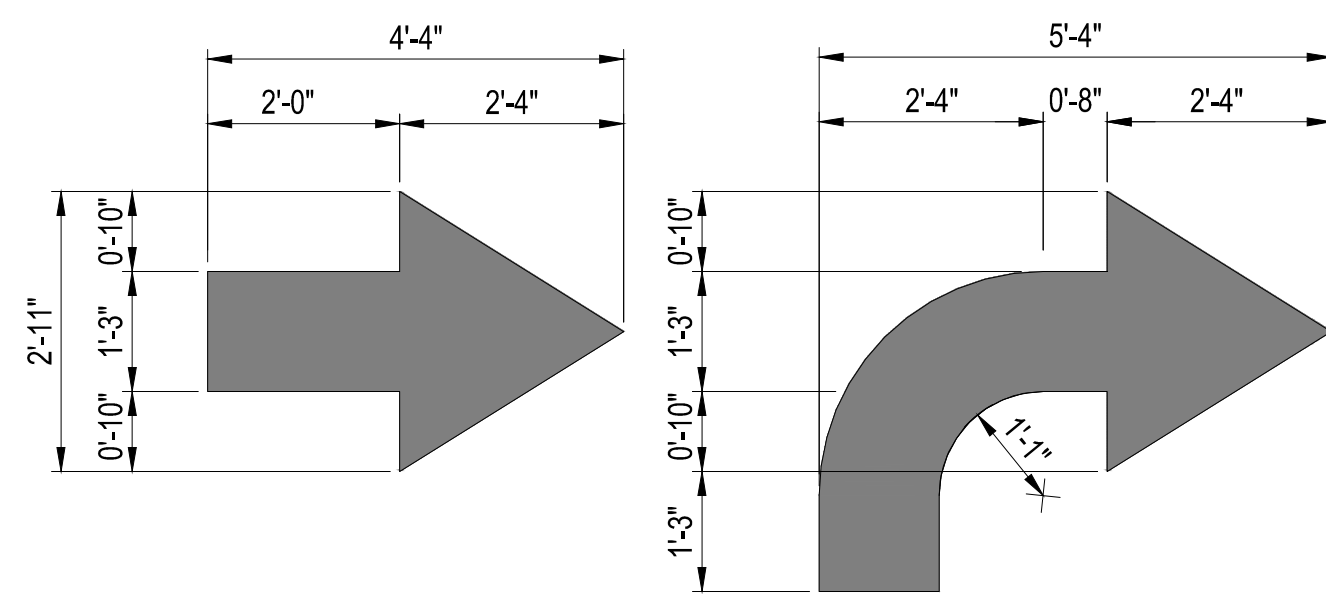

NOTE:  
SYMBOLS TO BE PAINTED ON PAVEMENT AS PER SPECIFICATIONS

5 DIRECTIONAL ARROW DETAILS  
C502 SCALE: NONE

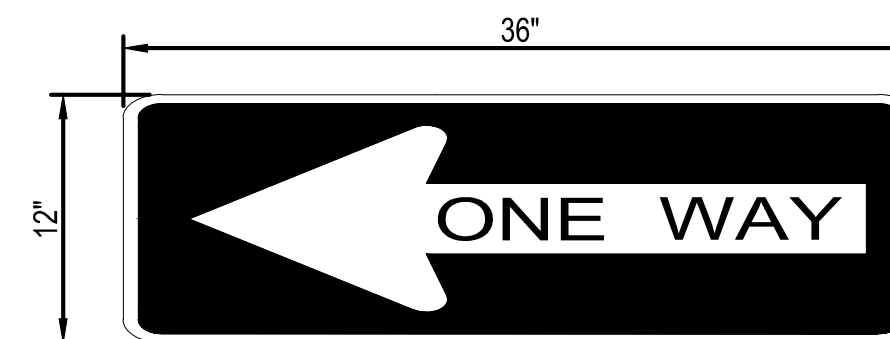
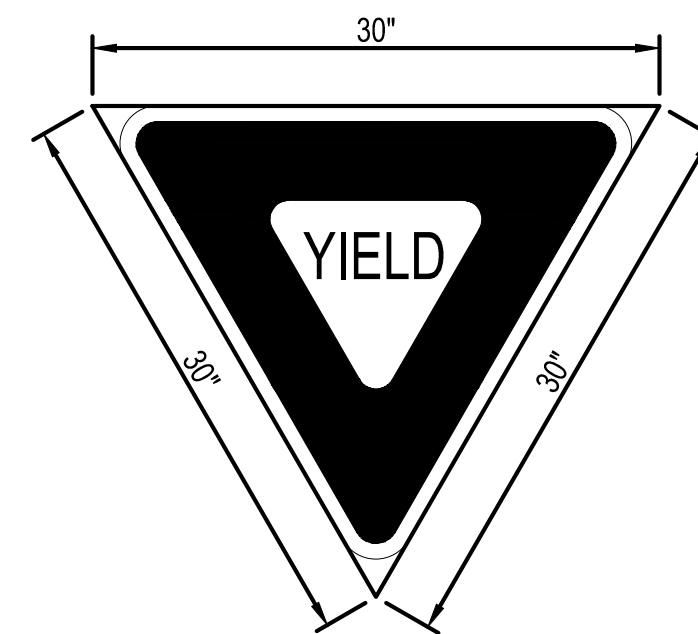
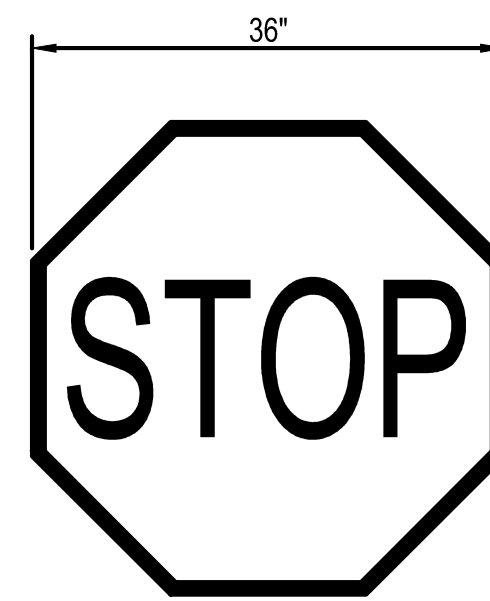

R6-1(L)



R6-1(R)

R1-1  
STOP

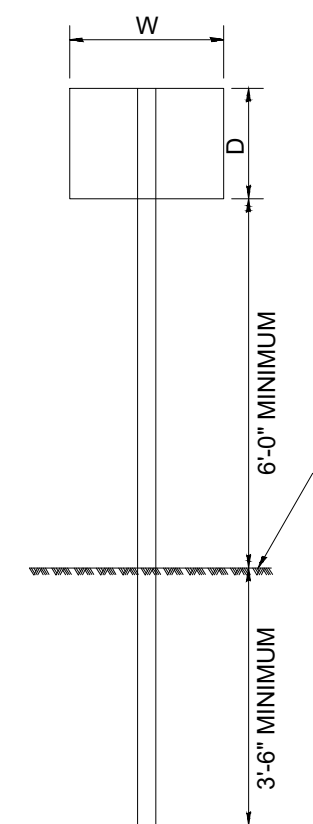

ONE POST INSTALLATION

R1-2  
YIELD

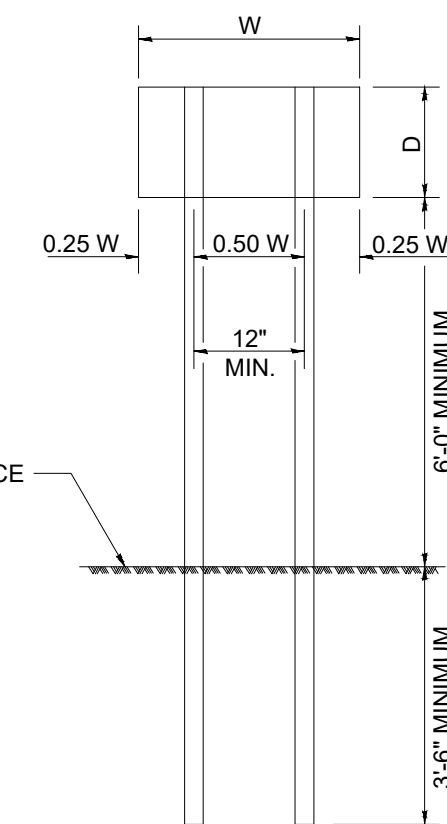

TWO POST INSTALLATION

R6-1  
ONE WAY

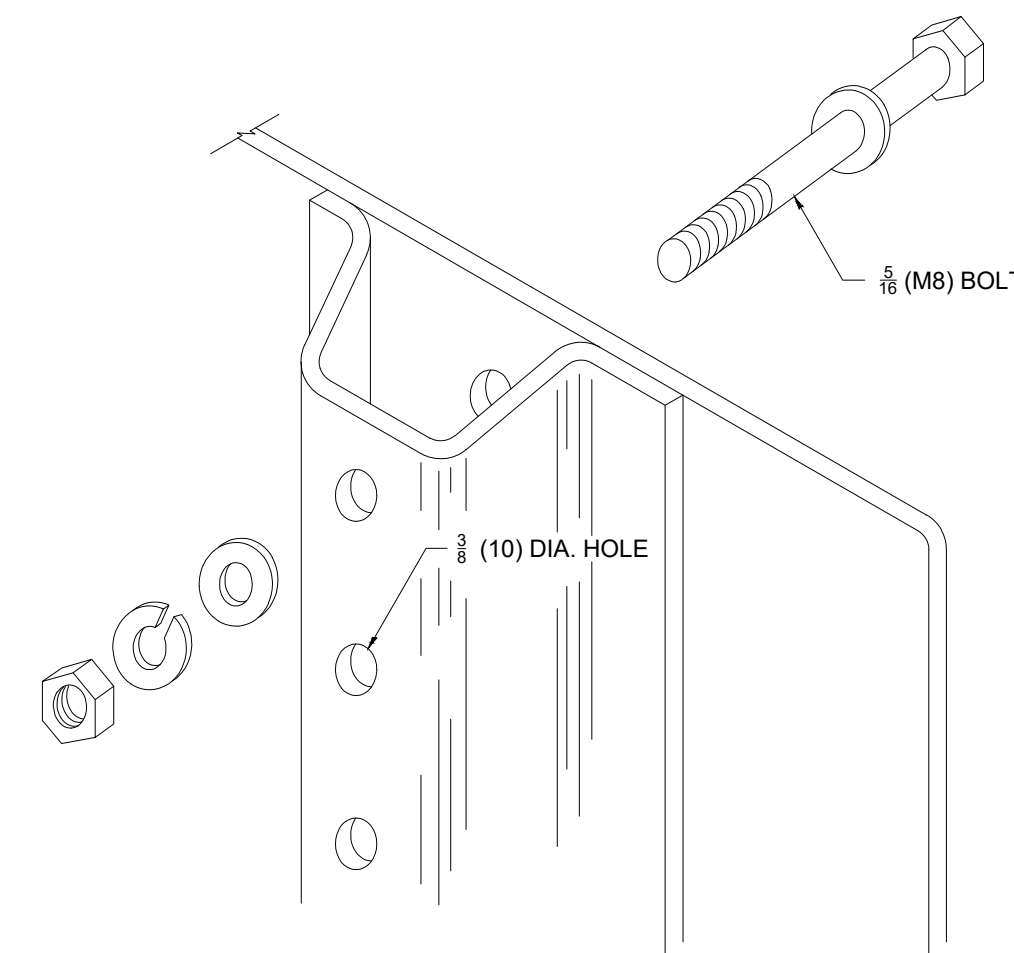

DETAIL OF MOUNTING SIT TO POST  
NOTE: MINIMUM OF 2 BOLTS PER POST REQUIRED

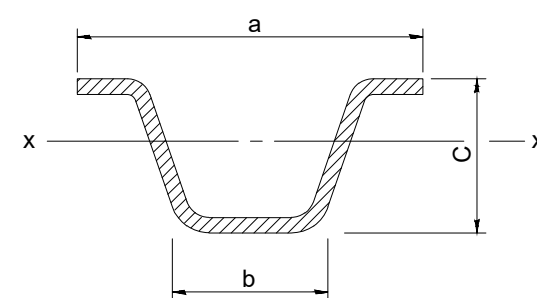

POST SECTION

TYPE A SIGN POST	STEEL	ALUMINUM	a	b	c	Sx-x CU. IN.	LBS/FT
			3 1/8	1 1/4	1 1/8	0.223	2.00
			3 1/2	1 5/8	1 1/2	0.435	0.90

3 SIGN DETAILS  
C502 SCALE: NONE

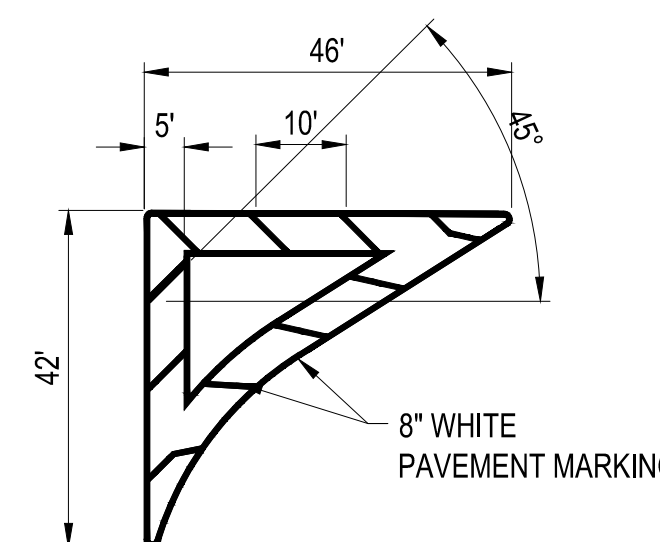
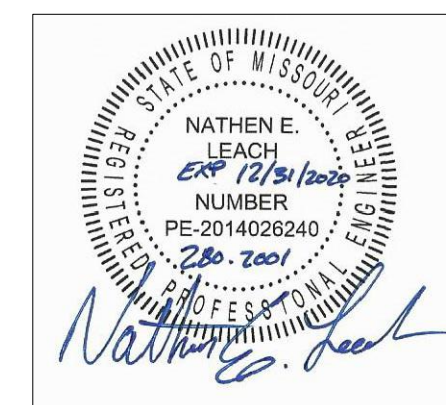

6 PAVEMENT MARKING DETAIL  
C502 SCALE: NONE

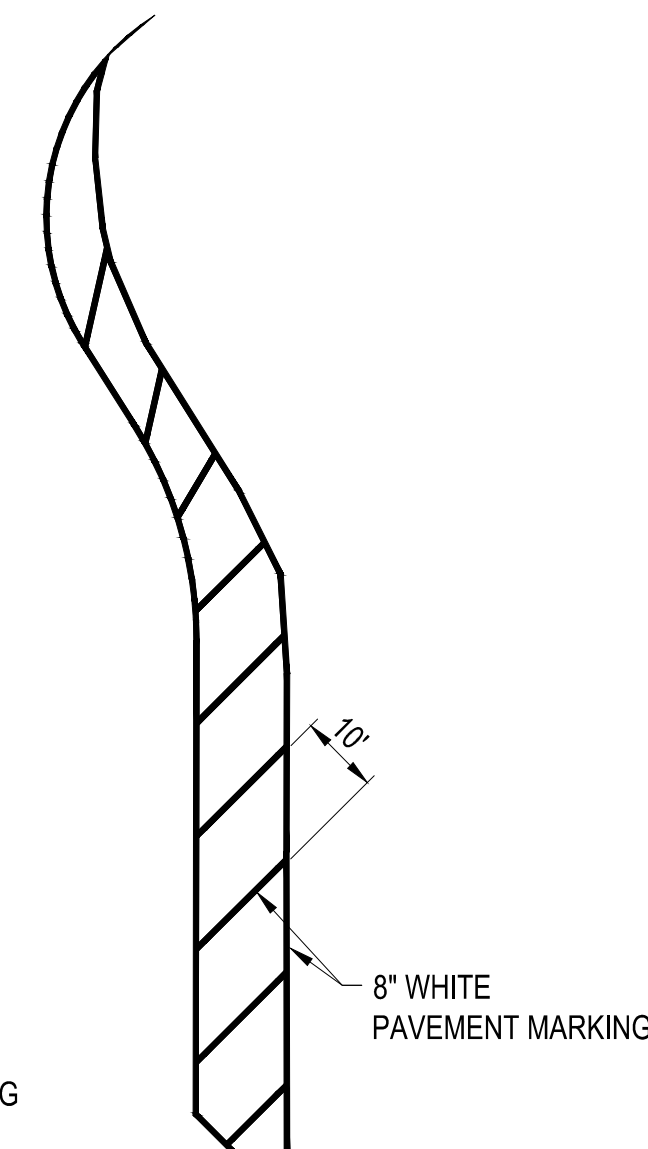



APR 22, 2020 3:42 PM NLEACH  
I:\JOBS\2020\280-2001 RALLS COUNTY SCHOOL PARKING LOT & BASEBALL FIELD\DRAWINGS\280-2001 SITE DETAILS.DWG

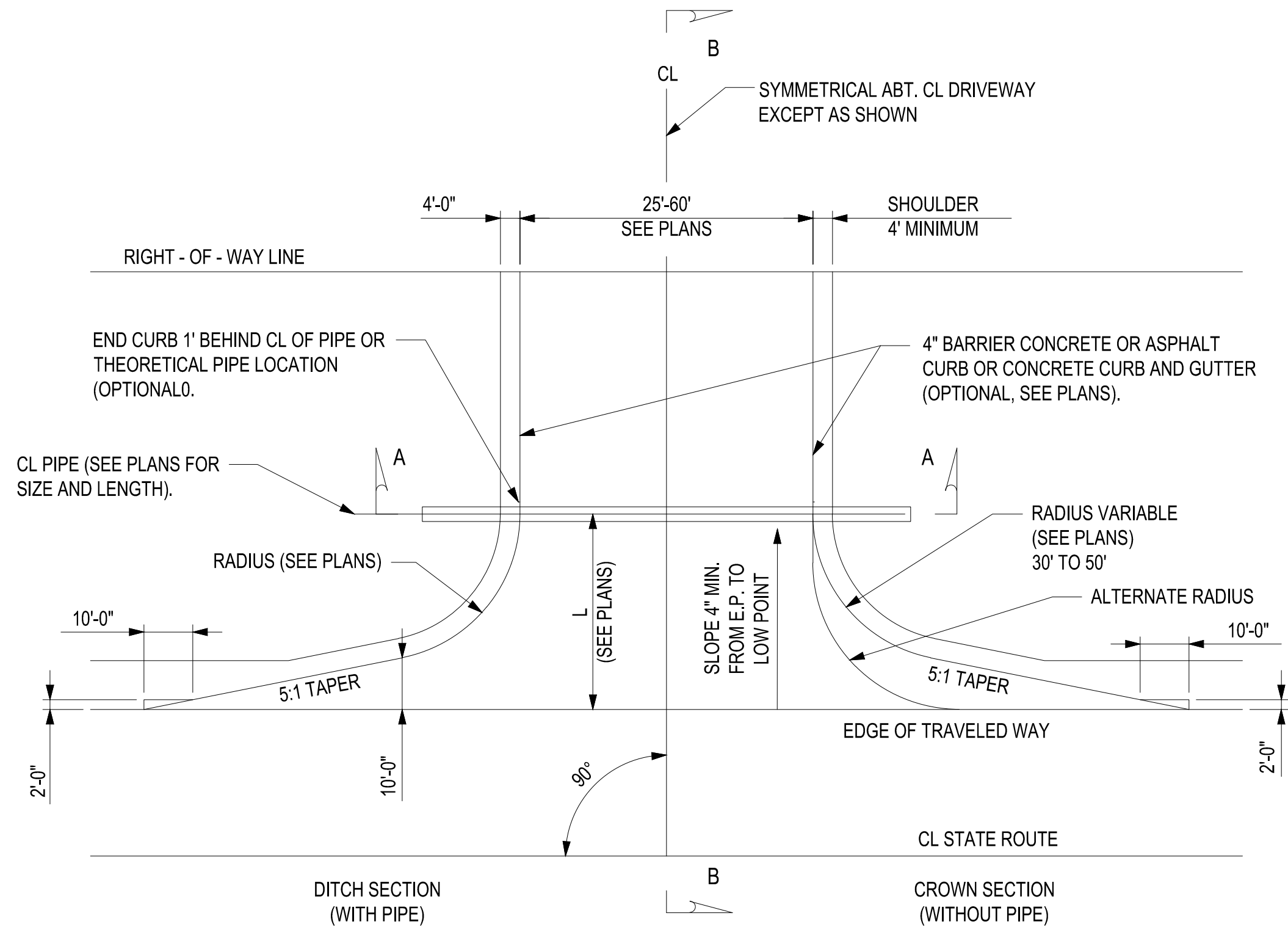

PLAN VIEW  
ENTRANCE DETAILS  
1  
C503 SCALE: NONE

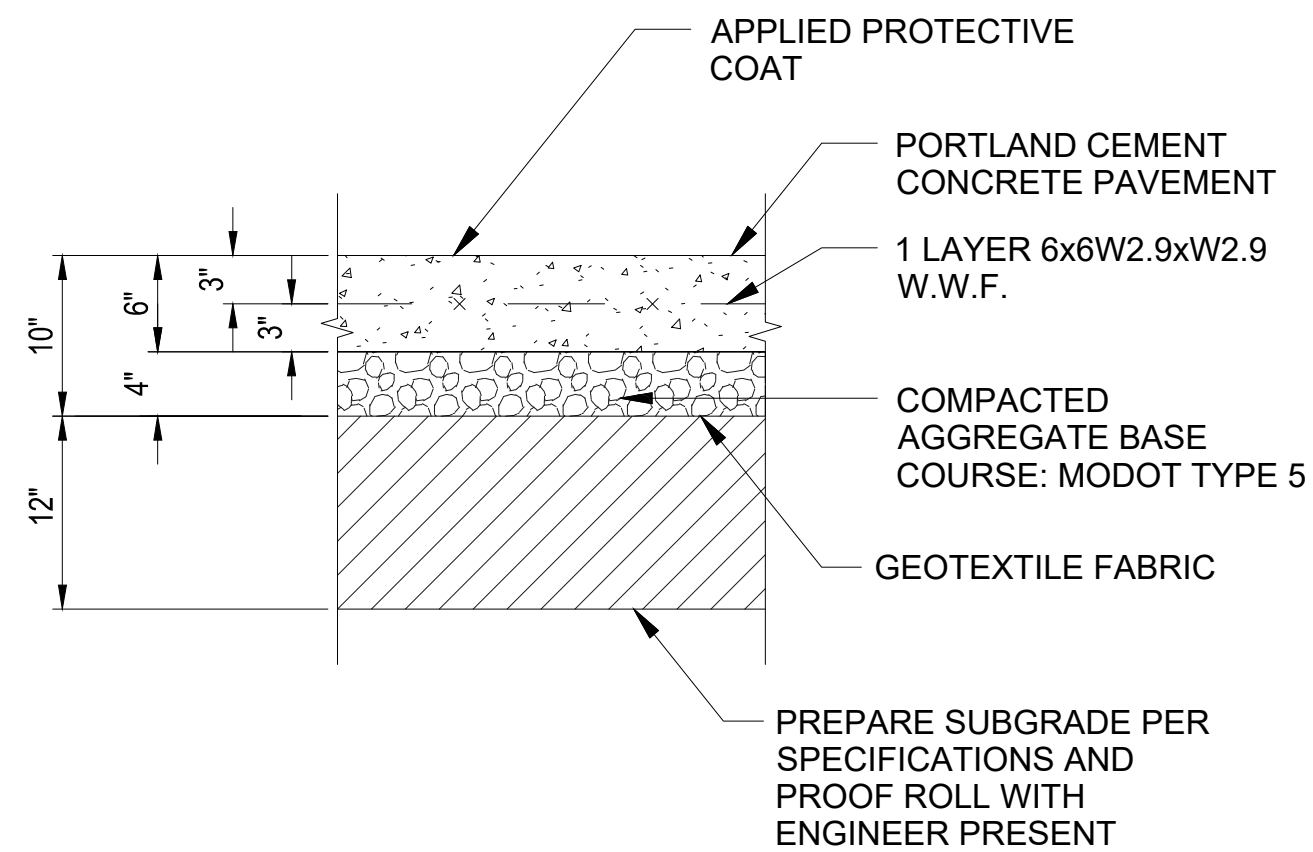

2 PORTLAND CEMENT PAVING DETIAL  
C503 SCALE: NONE

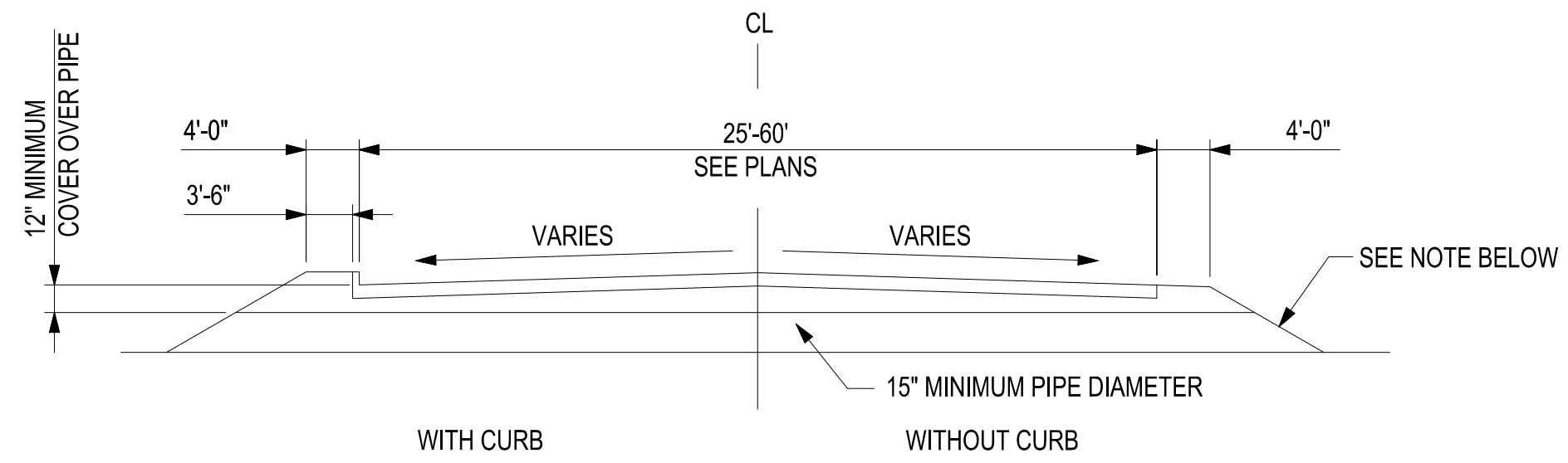

SECTION A-A

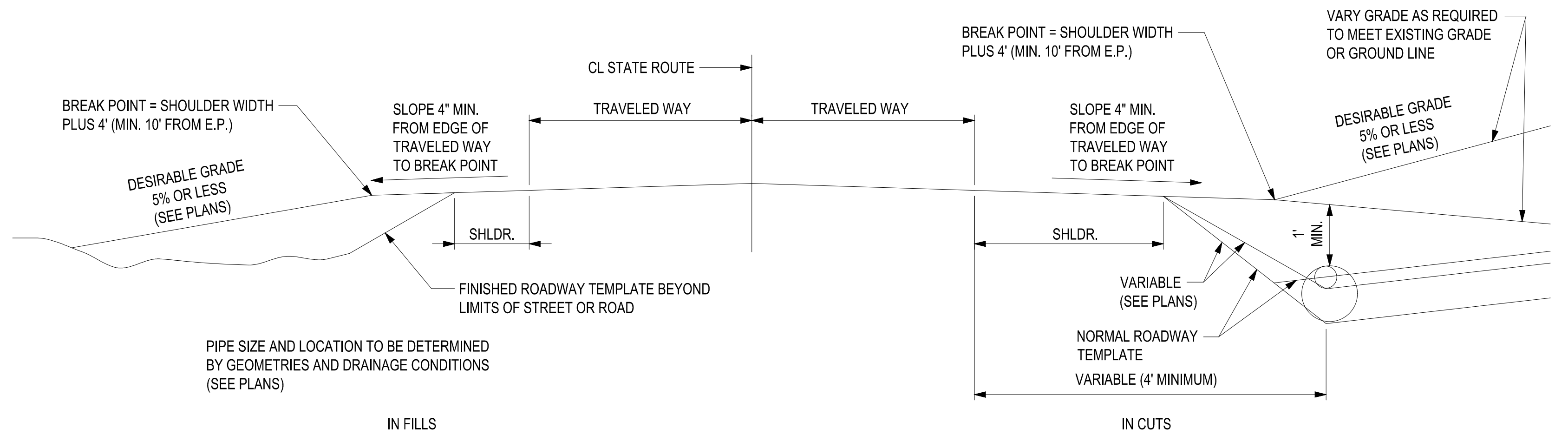

SECTION B-B

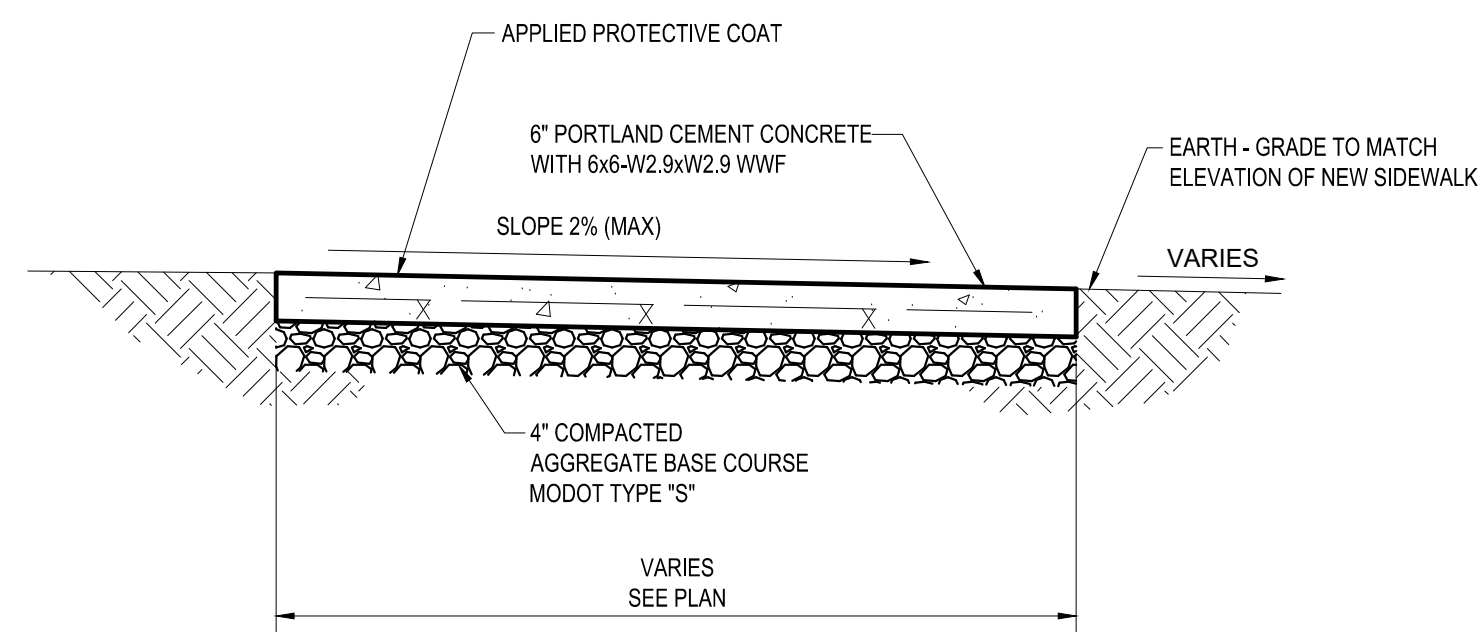

3 SIDEWALK DETAIL  
C503 SCALE: NONE

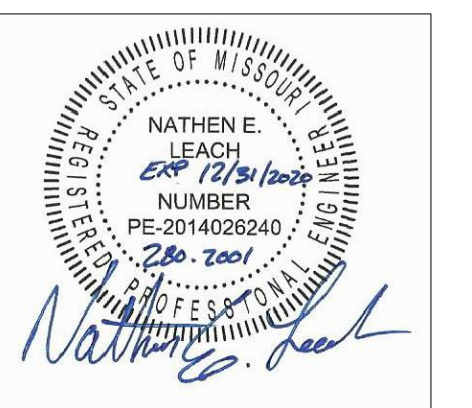



APR 22, 2020 3:44 PM NLEACH  
I:\JOBS\2020\280-2001 RALLS COUNTY SCHOOL PARKING LOT & BASEBALL FIELD\DRAWINGS\SHEET\280-2001\_SITE DETAILS.DWG

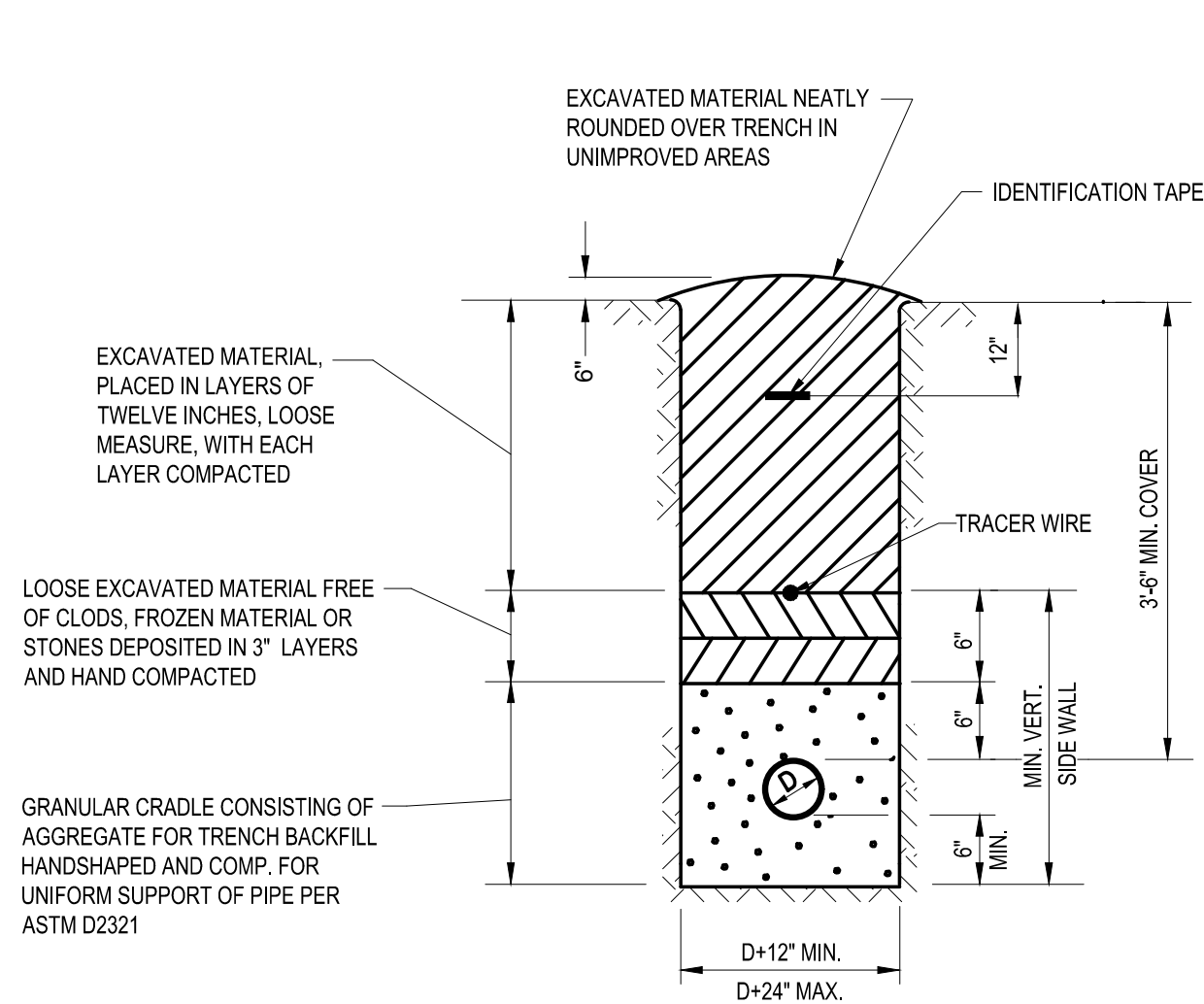

**1 TRENCH DETAIL UNIMPROVED AREAS**  
C504 SCALE: NONE

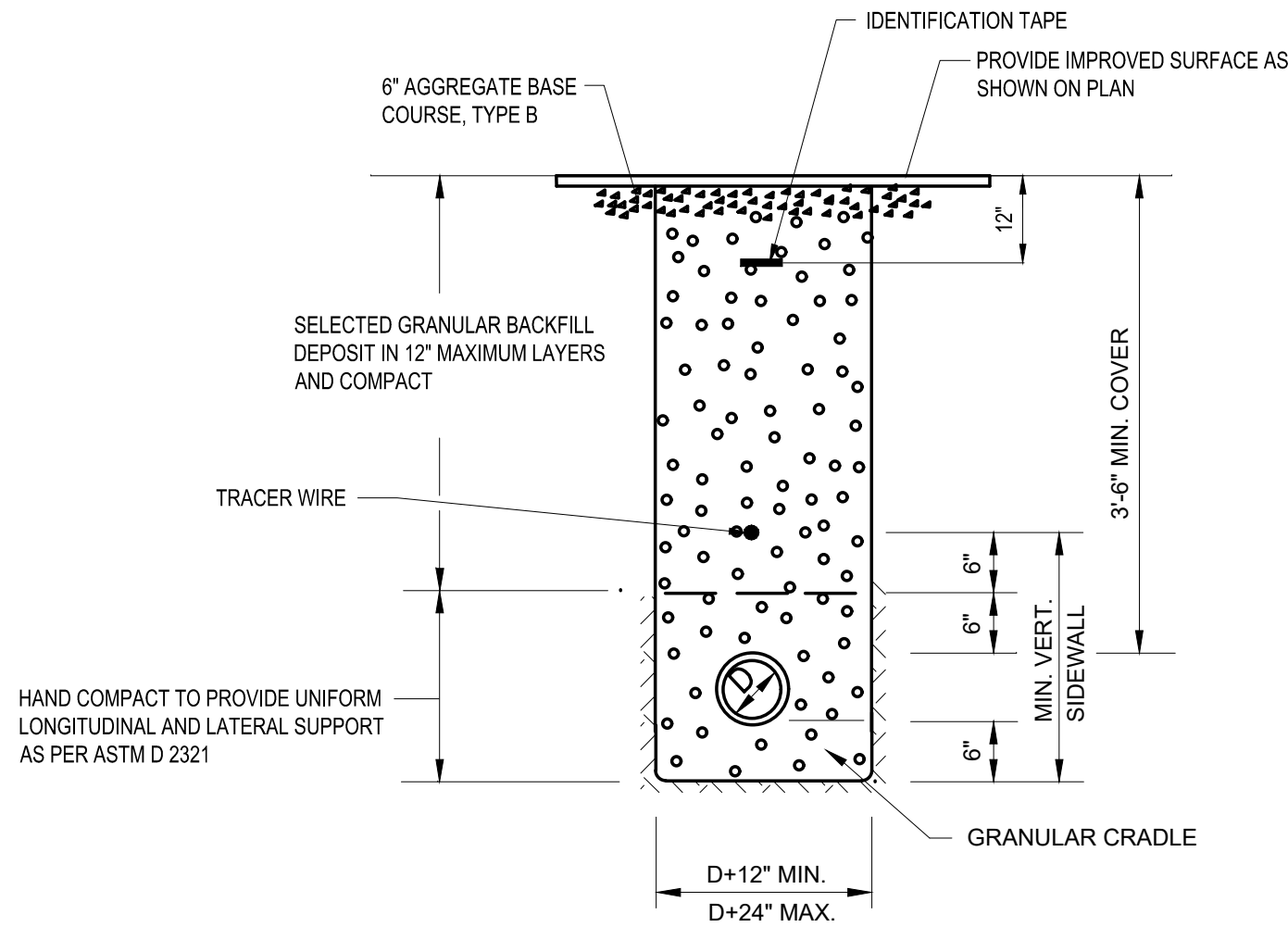

**2 TRENCH DETAIL IMPROVED AREAS**  
C504 SCALE: NONE

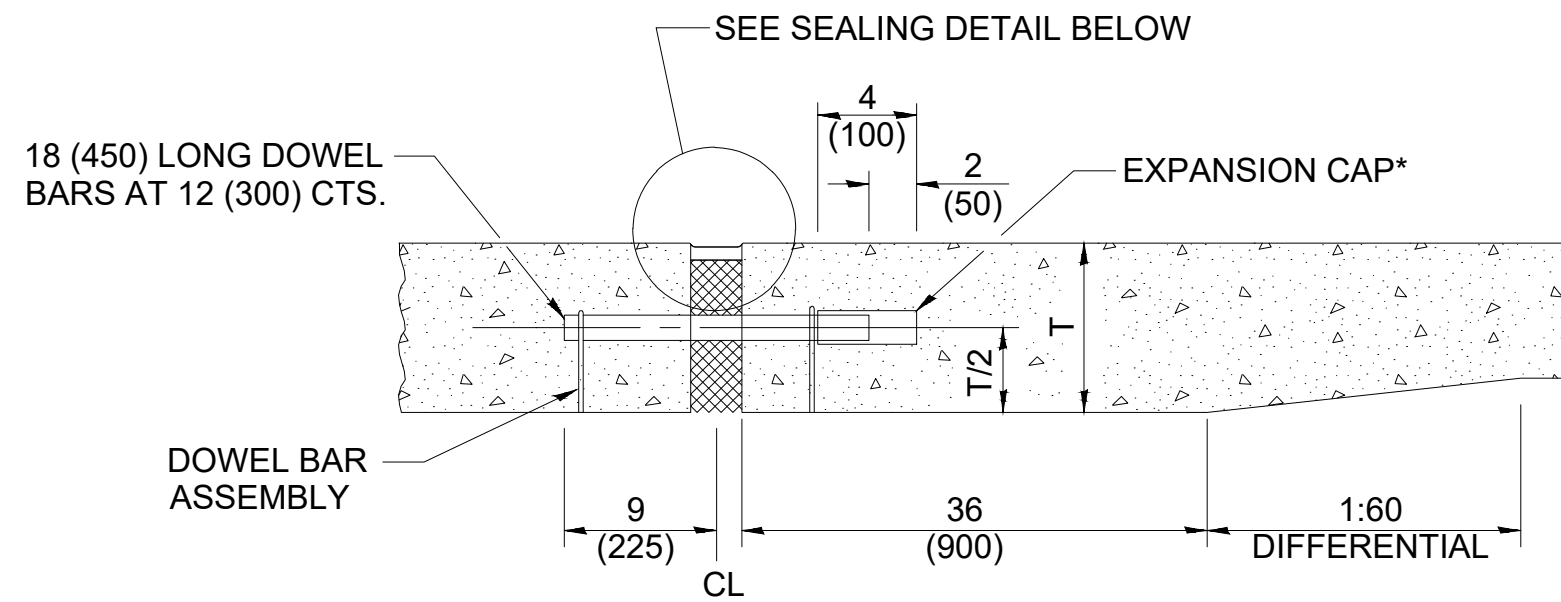
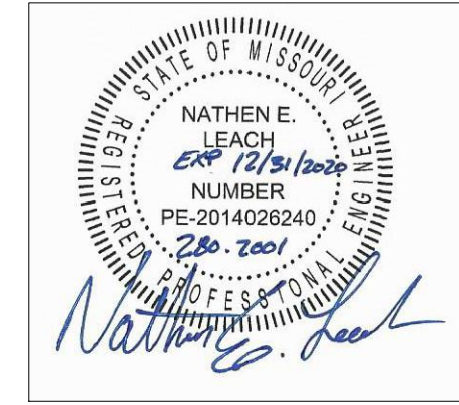

**TRANSVERSE EXPANSION JOINT**  
(FOR PAVEMENTS WITH UNEQUAL THICKNESS)

\* EXPANSION CAPS SHALL BE INSTALLED ON THE EXPOSED END OF EACH DOWEL BAR ONCE THE HEADER HAS BEEN REMOVED AND THE JOINT FILLER MATERIAL HAS BEEN INSTALLED

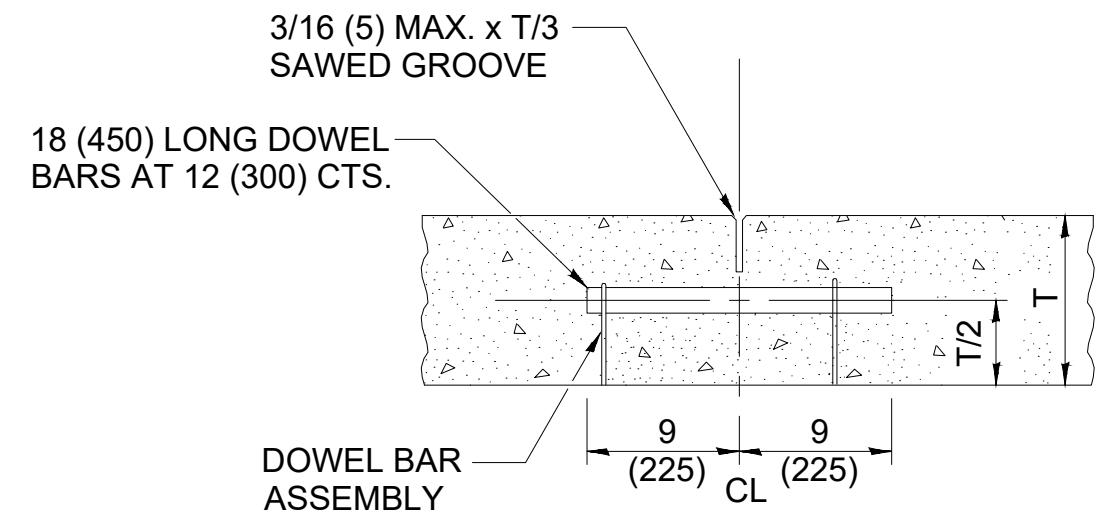

**TRANSVERSE CONTRACTION JOINT**

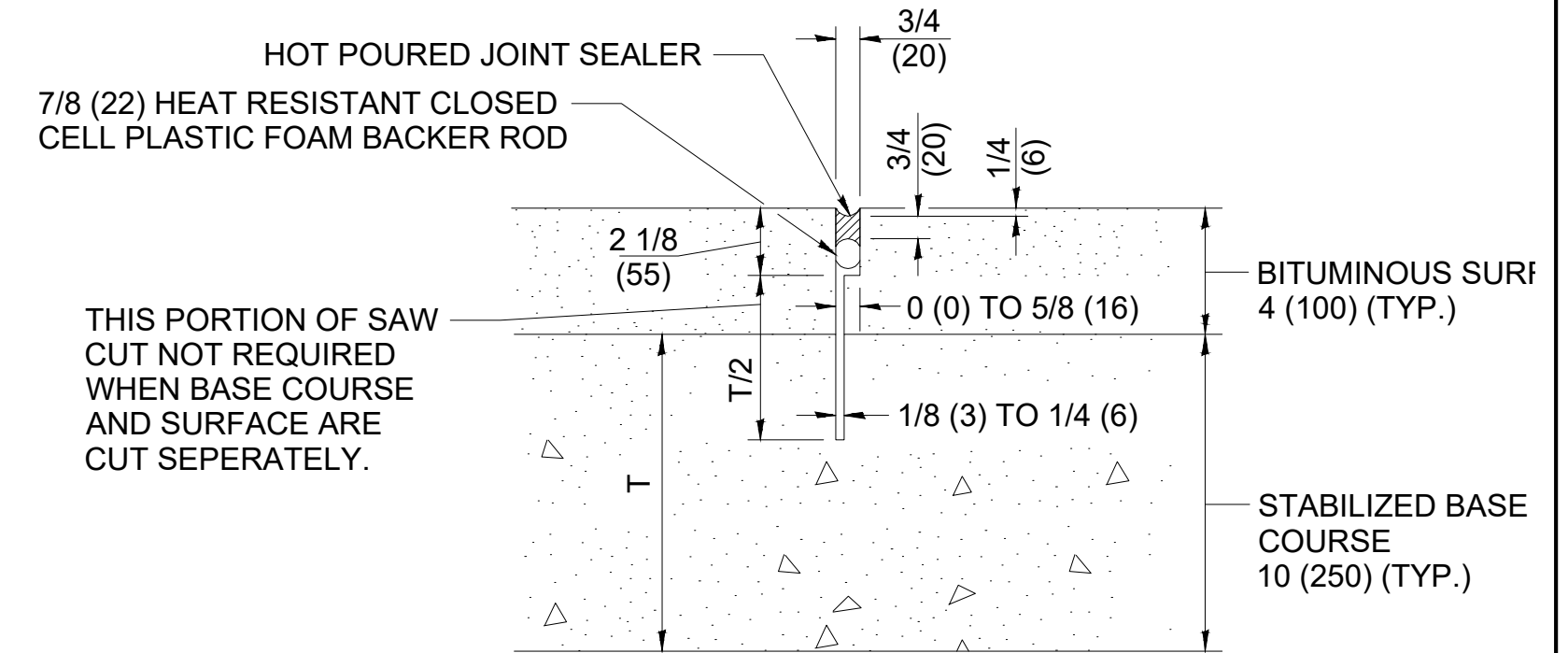

**TRANSVERSE CONTRACTION JOINT**  
(FOR CAM, CFA, AND LFA BASE COURSE MIXTURES)

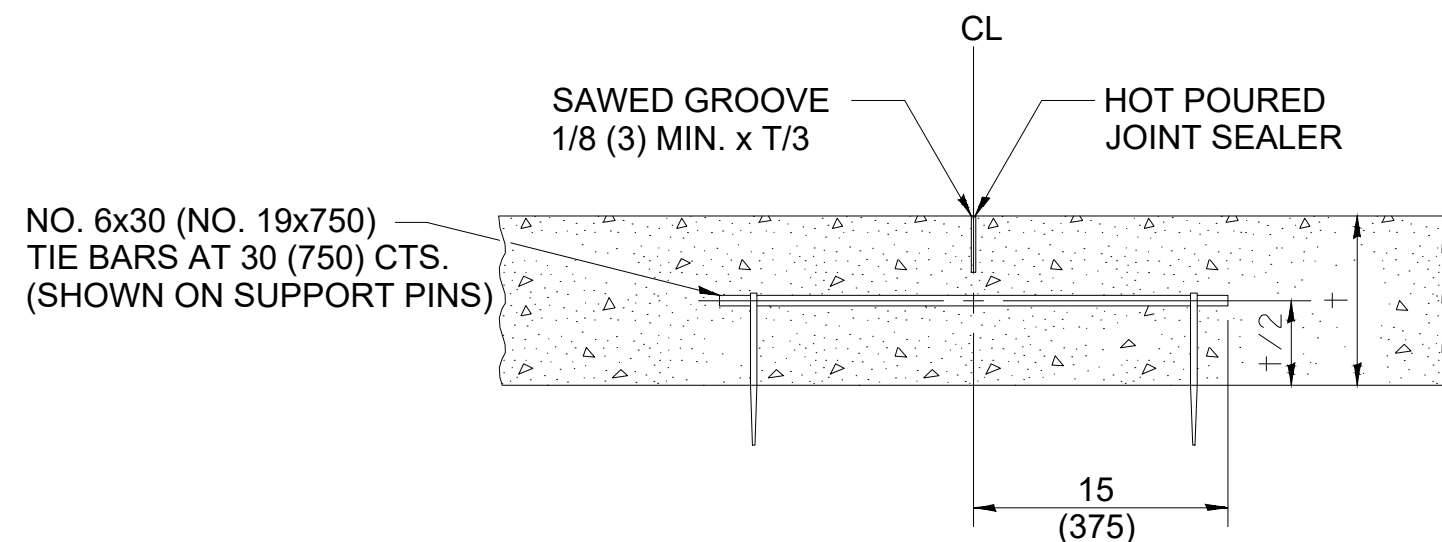

**LONGITUDINAL SAWED JOINT**

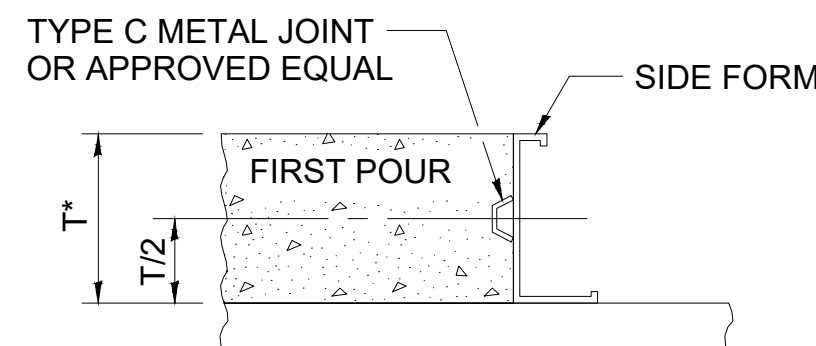

**LONGITUDINAL KEYED JOINT**  
\*8 (203) MIN. PAVEMENT THICKNESS FOR KEYED JOINTS

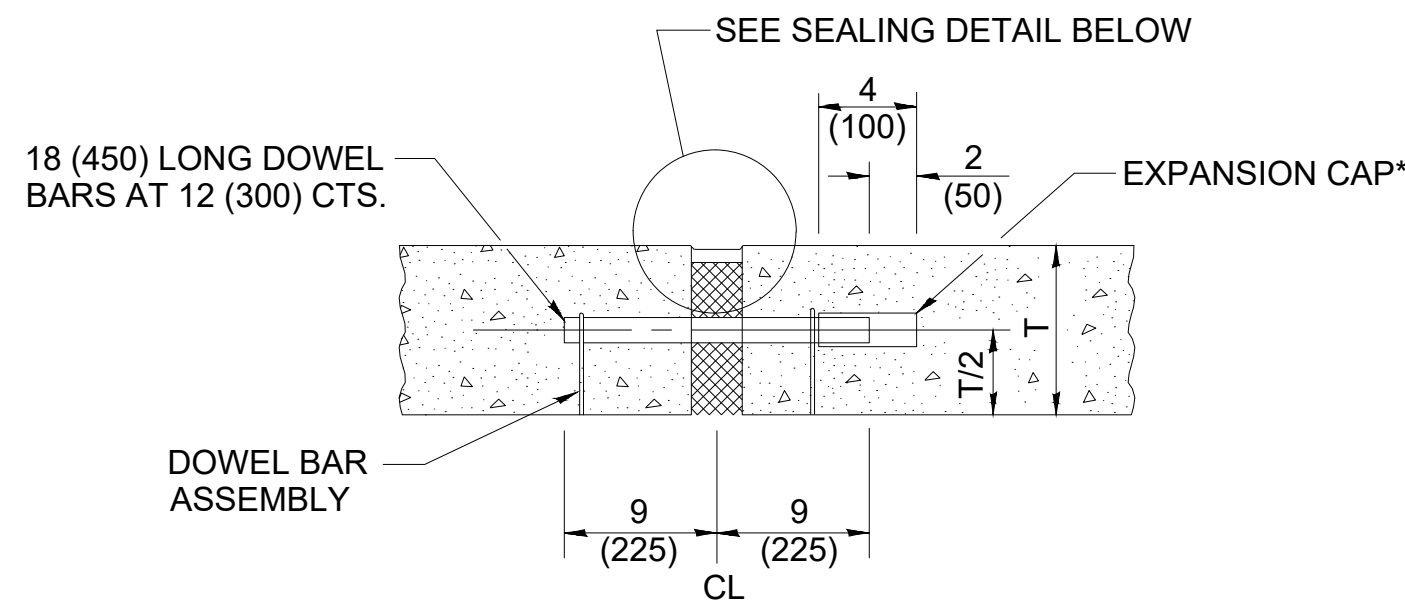

**TRANSVERSE EXPANSION JOINT**  
(FOR PAVEMENTS WITH EQUAL THICKNESS)

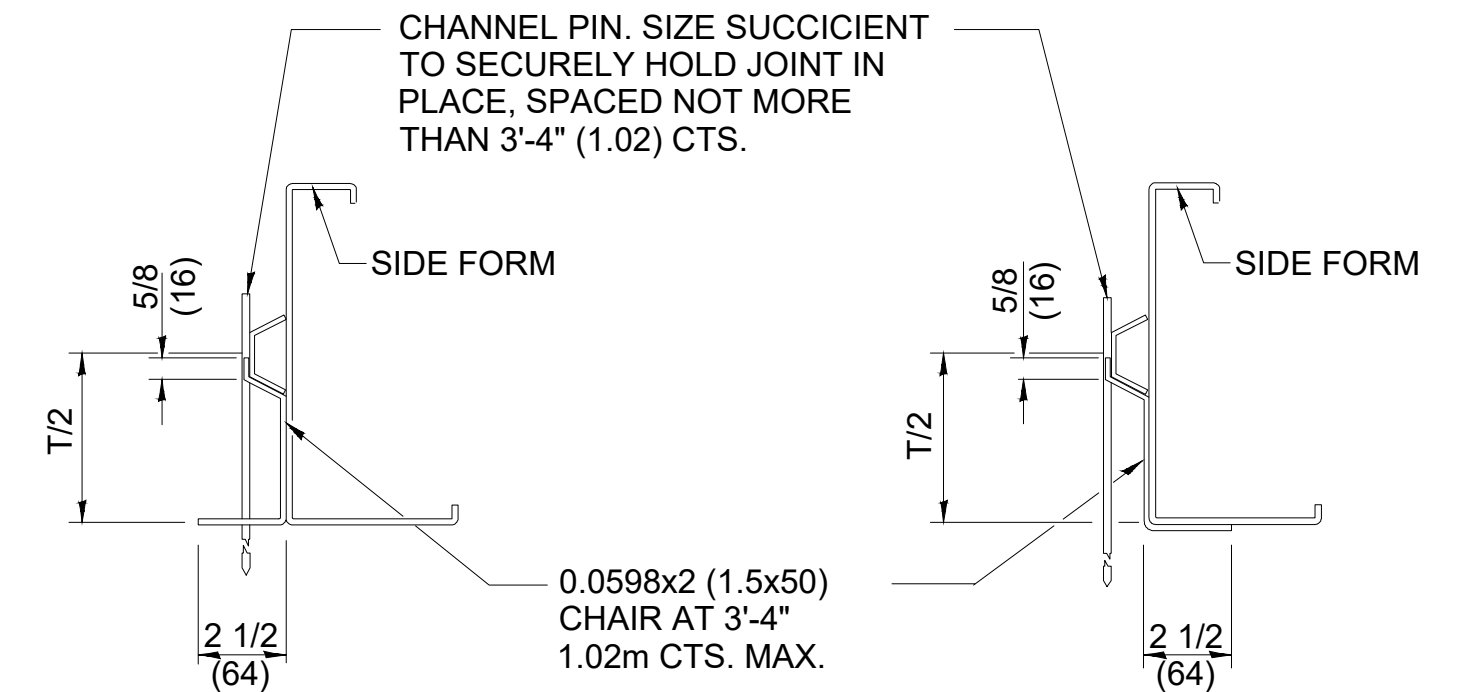

**SUPPORTING CHAIR ALTERNATE**

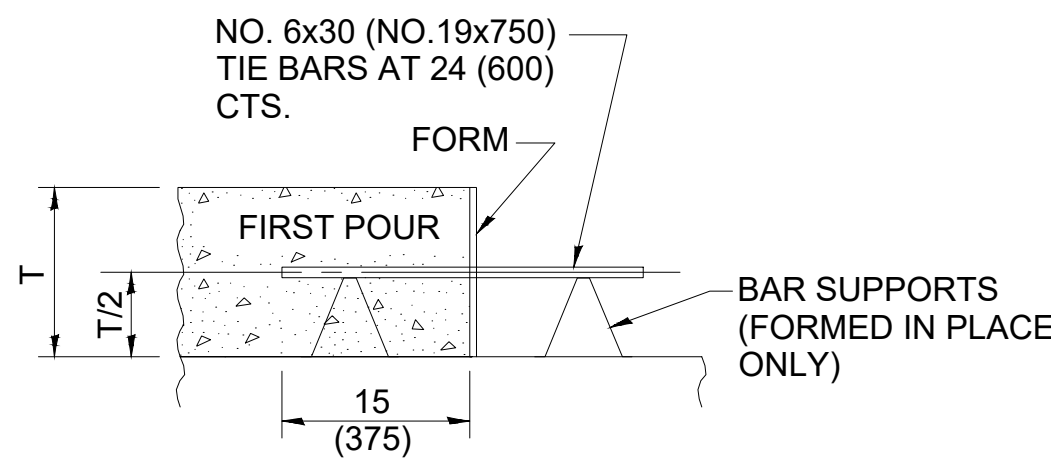

**LONGITUDINAL CONSTRUCTION JOINT**  
(TIE BAR FORMED IN PLACE OR MECHANICALLY INSERTED)

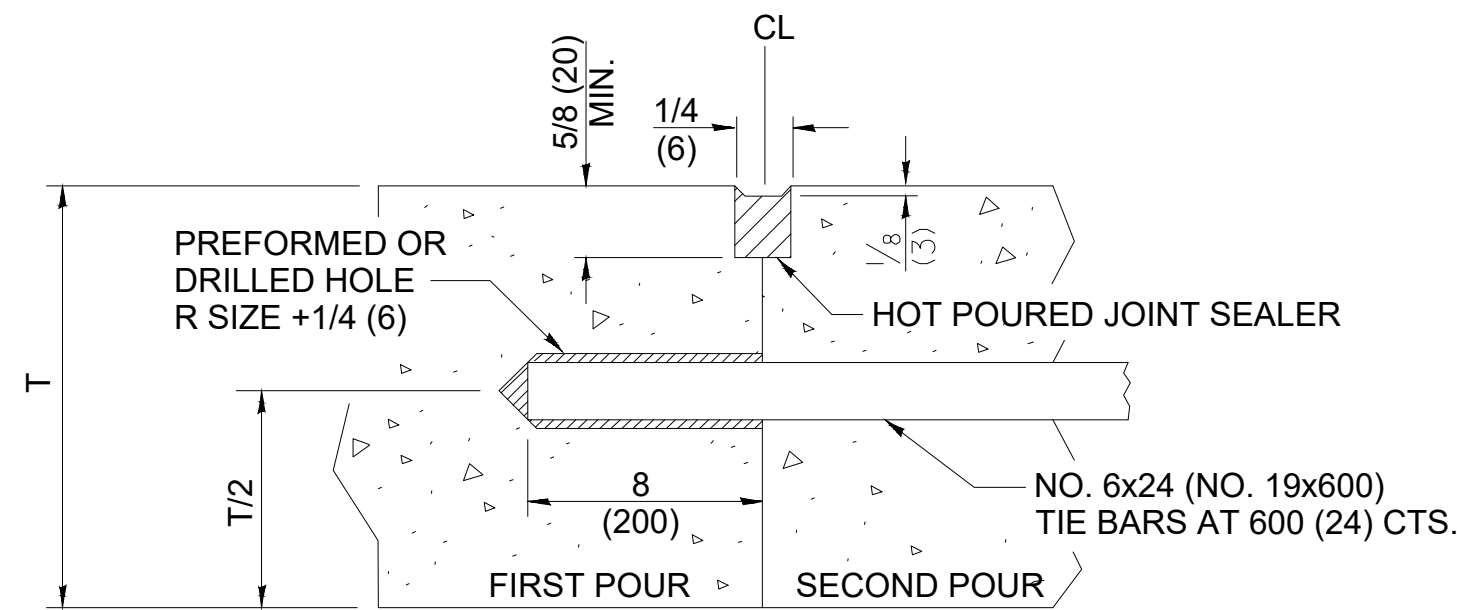

**LONGITUDINAL CONSTRUCTION JOINT**  
(TIE BAR GROUTED IN PLACE)

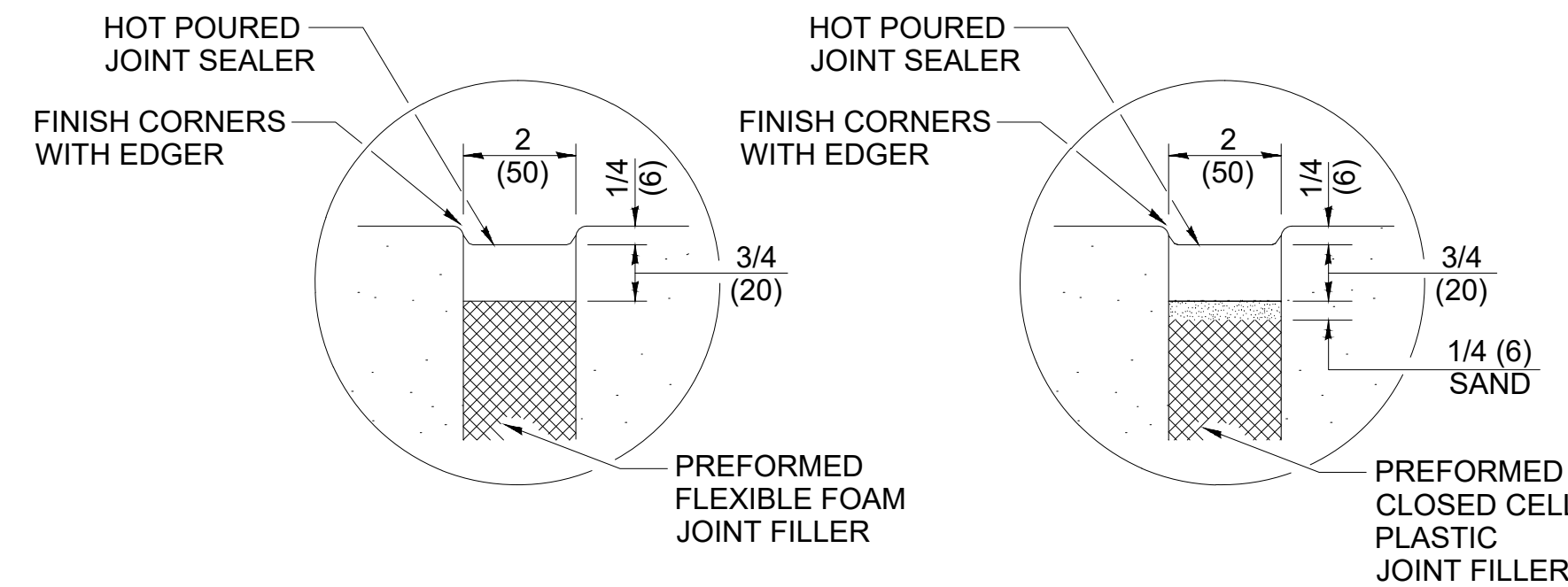

**SEALING DETAIL**

**3 PAVEMENT JOINTING DETAILS**  
C504 SCALE: NONE





### GENERAL NOTES

ALL SLOPE RATIOS ARE EXPRESSED AS UNITS OF VERTICAL DISPLACEMENT TO UNITS OF HORIZONTAL DISPLACEMENT (V:H).

ALL DIMENSIONS ARE IN INCHES (MILLIMETERS) UNLESS OTHERWISE SHOWN.

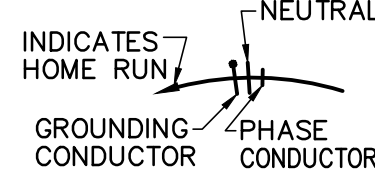

APR 22, 2020, 3:25 PM GCLLUM  
I:\JOBS\2020\280.2001 RALLS COUNTY SCHOOL PARKING LOT & BASEBALL FIELD\DRAWINGS\SHEET\E101 GENERAL NOTES.DWG

LINE TYPES & SYMBOLS		
	NEUTRAL	BRANCH CIRCUIT — ROUTED IN CONDUIT
	PHASE CONDUCTOR	
		UNDERGROUND PULL BOX
		POWER PANEL
		SITE LIGHT FIXTURE

ABBREVIATIONS		
A/E	ARCHITECT/ENGINEER	
A.F.F.	ABOVE FINISHED FLOOR	
AWG	AMERICAN WIRE GAUGE	
CLR	CLEAR	
DEG.	DEGREES	
EFF.	EFFICIENCY	
EST. E.S.P.	ESTIMATED EXTERIOR STATIC PRESSURE	
F	DEGREES FAHRENHEIT	
FLA	FULL LOAD AMPS	
FT.	FOOT	
GA.	GAUGE	
G.C.	GENERAL CONTRACTOR	
GND.	GROUND	
HZ	HERTZ	
IN	INCH	
KW	KILOWATT	
LBS	POUNDS	
LED	LIGHT EMITTING DIODE	
MANUF.	MANUFACTURERS	
MAX.	MAXIMUM	
MCA	MINIMUM CIRCUIT AMPS	
MIN.	MINIMUM	
NEMA	NATIONAL ELECTRICAL MANUFACTURERS ASSOCIATION	
NO.	NUMBER	
NOM	NOMINAL	
N.T.S.	NOT TO SCALE	
O.C.	ON CENTER	
PP—X	POWER PANEL	
PVC	POLYVINYL CHLORIDE	
QTY	QUANTITY	
RE:	REFERENCE	
RLA	RATED LOAD AMPS	
R.M.C.	RIGID METAL CONDUIT	
SCH.	SCHEDULE	
TYP	TYPICAL	
UL	UNDERWRITERS LABORATORIES	
US	UNSWITCHED	
W/	WITH	

- GENERAL NOTES:**
- THE LAYOUTS SHOWN ON THESE SHEETS ARE NECESSARILY DIAGRAMMATIC BUT SHALL BE FOLLOWED AS CLOSELY AS ACTUAL CONSTRUCTION AND AS OTHER WORK WILL PERMIT. CHANGES FROM THESE DRAWINGS REQUIRED TO MAKE THIS WORK CONFORM TO THE BUILDING CONSTRUCTION OR OTHER WORK OF OTHER TRADES SHALL BE MADE BY THE CONTRACTOR WITHOUT ADDITIONAL COST TO THE OWNER, BUT ONLY WITH THE PRIOR APPROVAL OF THE ENGINEER. ALL MAJOR CHANGES SHALL BE SHOWN ON SHOP DRAWINGS AND NOTED AS SUCH TO BE SUBMITTED BEFORE THE CHANGES ARE MADE. ALL NEW EQUIPMENT SHALL CONNECT TO EXISTING SERVICES UNLESS SHOWN OTHERWISE.
  - COORDINATE ALL PENETRATIONS THROUGH FIRE—RATED WALLS WITH GENERAL CONTRACTOR AND SEAL WITH FIRE SEALANT AND MAKE WEATHER TIGHT.
  - ELECTRICAL CONTRACTOR SHALL COORDINATE INSTALLATION OF ALL EQUIPMENT WITH ALL OTHER TRADES AND CONTRACTORS. COORDINATE FINAL LOCATION OF ALL EQUIPMENT WITH THE GENERAL CONTRACTOR.
  - CONTRACTOR SHALL MODIFY TYPED CIRCUIT DESCRIPTION ON PANEL (G) INDEX CARD AS INDICATED ON THE PLANS.
  - ALL ELECTRICAL EQUIPMENT SHALL BE INSTALLED IN CONFORMANCE WITH NFPA 70 — NATIONAL ELECTRICAL CODE (NEC), (2017), THE RESPECTIVE EQUIPMENT MANUFACTURER'S DIRECTIONS AND ALL OTHER APPLICABLE LOCAL CODES, LAWS, ORDINANCES, AND REQUIREMENTS IN FORCE. ANY INSTALLATIONS WHICH VOID MANUFACTURER'S WARRANTY OF A DEVICE WILL NOT BE PERMITTED.
  - PROVIDE GROUNDING BUSHINGS WITH GROUND WIRE BONDING JUMPERS FOR ALL METAL CONDUITS ENTERING/LEAVING METERING EQUIPMENT AND SERVICE EQUIPMENT ENCLOSURES.
  - THE CONTRACTOR SHALL VISIT THE SITE AND CAREFULLY EXAMINE THOSE PORTIONS OF THE BUILDING AND/OR SITE AFFECTED BY THIS WORK SO AS TO BECOME FAMILIAR WITH EXISTING CONDITIONS AND DIFFICULTIES THAT MAY AFFECT EXECUTION OF THE WORK. SUBMISSION OF A PROPOSAL WILL BE CONSTRUED AS EVIDENCE THAT SUCH EXAMINATION HAS BEEN MADE. LATER CLAIMS FOR LABOR, EQUIPMENT AND/OR MATERIALS REQUIRED DUE TO DIFFICULTIES ENCOUNTERED THAT COULD HAVE REASONABLY BEEN OBSERVED BY THE CONTRACTOR WILL NOT BE RECOGNIZED. COORDINATE ACCESS TO THE FACILITY WITH THE A/E AND OWNER'S REPRESENTATIVE.

LIGHTING SCHEDULE							
TAG	MANUFACTURER	CATALOG NO.	VOLTS	LAMPING		MOUNTING TYPE	REMARKS
				WATTS	TYPE		
A	SIGNIFY GARDCO	ECF—S—48L—1.2A—NW—G2—AR—3	208	183	LED	POLE	1,3
B	SIGNIFY GARDCO	ECF—S—48L—1.2A—NW—G2—AR—3	208	183	LED	POLE	2,3

**REMARKS:**

- PROVIDE BLACK FINISH, MOUNTED ON 25' TALL, 5"Ø ROUND, STEEL POLE.
- PROVIDE BLACK FINISH, MOUNTED ON 15' TALL, 5"Ø ROUND, STEEL POLE.
- PROVIDE PROGRAMMABLE DIMMING, OCCUPANCY, AND DAYLIGHT SENSORS — PHOTOCCELL CONTROL SHALL TURN FIXTURE ON TO "LOW LEVEL" MODE (50%), FIXTURE SHALL TURN ON TO "HIGH LEVEL" MODE (100%) WHEN OCCUPANCY IS SENSED. AFTER A PERIOD OF 15 MINUTES FIXTURE SHALL RETURN TO "LOW LEVEL". ALL TIMES AND LEVELS SHALL BE ADJUSTABLE.



*Matthew J. Fuller*

DATE: 04—24—2020  
EXP. DATE: 12—31—2021

DRAWING DATE	04/24/2020	REVISION 1	
SURVEYED BY		BY & DATE	
DRAWN BY	MJF 04/24/20	REVISION 2	
CHECKED BY	___/___/___	BY & DATE	

PEI PROJECT NO.	280.2001
PROJECT NAME	RALLS COUNTY R-II PARKING EXPANSION
FILENAME	E101 GENERAL NOTES.dwg
DRAWING SCALE	NONE



APR 22, 2020, 3:43 PM GCLLW  
I:\JOBS\2020\280.2001 RALLS COUNTY SCHOOL PARKING LOT & BASEBALL FIELD\DRAWINGS\SHEET\E201 LIGHTING SITE PLANDWG

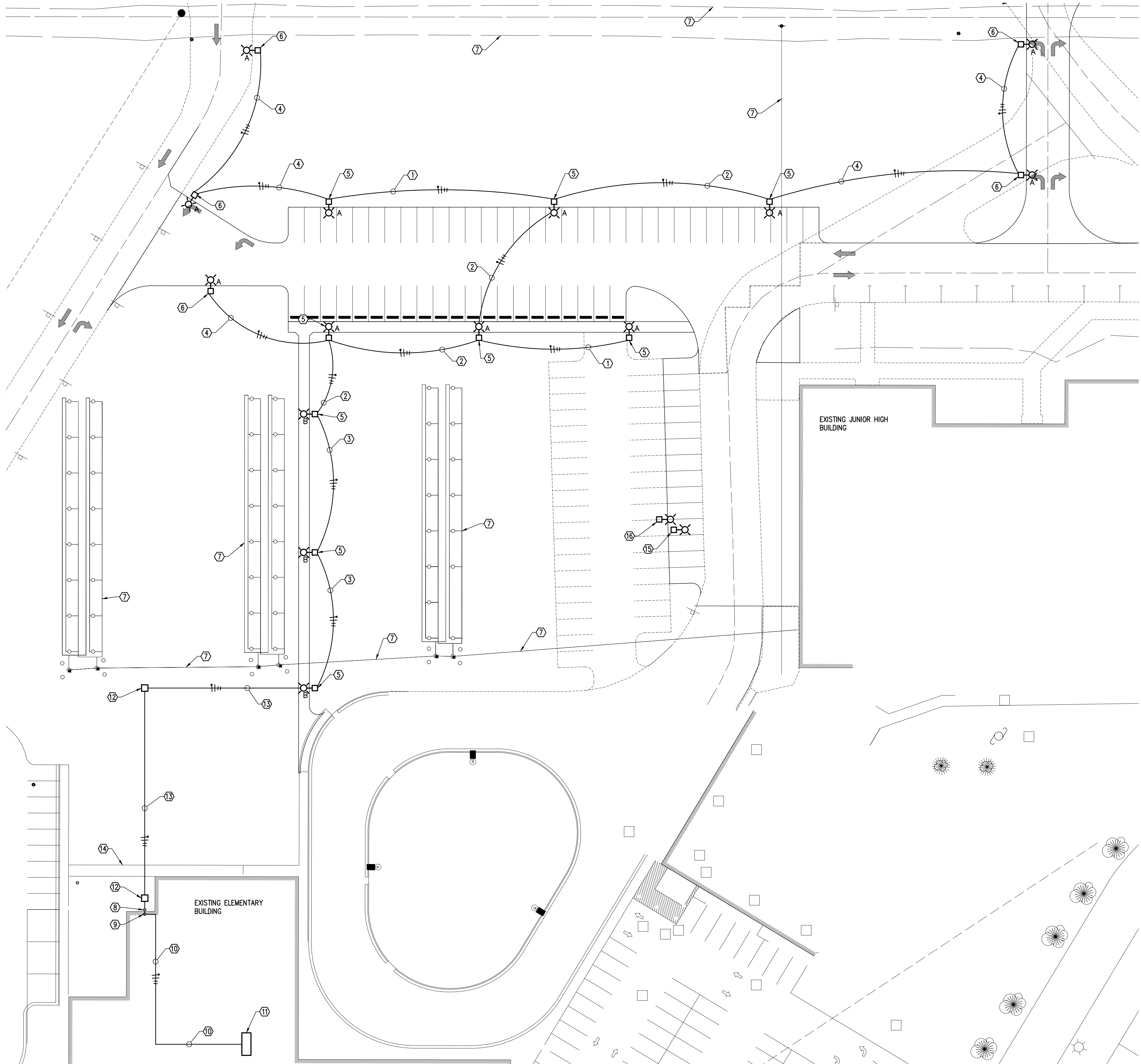

#### KEYED NOTES:

- ① BY BASE BID, PROVIDE (3) #6 AND #8 GROUND IN 1-1/2" SCH 40 PVC CONDUIT.
- ② BY BASE BID, PROVIDE (3) #4 AND #6 GROUND IN 1-1/2" SCH 40 PVC CONDUIT.
- ③ BY BASE BID, PROVIDE (3) #2 AND #4 GROUND IN 2" SCH 40 PVC CONDUIT.
- ④ BY ALTERNATE BID #1, PROVIDE (3) #6 AND #8 GROUND IN 1-1/2" SCH 40 PVC CONDUIT.
- ⑤ BY BASE BID, PROVIDE LIGHT FIXTURE AND POLE, AS SCHEDULED, SECURELY MOUNTED TO CONCRETE BASE. REFER TO DETAIL 1/E301 FOR ADDITIONAL INFORMATION.
- ⑥ BY ALTERNATE BID #1, PROVIDE LIGHT FIXTURE AND POLE, AS SCHEDULED, SECURELY MOUNTED TO CONCRETE BASE. REFER TO DETAIL 1/E301 FOR ADDITIONAL INFORMATION.
- ⑦ APPROXIMATE LOCATION OF EXISTING BELOW GRADE UTILITY. TAKE CARE NOT TO DAMAGE.
- ⑧ ROUTE CONDUCTORS/CONDUIT THROUGH WALL, AS CLOSE TO STAGE FLOOR AS POSSIBLE, AND DOWN EXTERIOR OF BUILDING TO BELOW GRADE AND OUT TO PULL BOX. ATTACH CONDUIT SECURELY TO BUILDING AT 36" INTERVALS. CORE DRILL WALL FOR CONDUIT PENETRATION AND SEAL ANNUAL SPACE WITH NON-SHRINK GROUT TO MAKE WATER AND WEATHER TIGHT. PAINT CONDUIT AND FASTENERS TO MATCH BUILDING COLOR.
- ⑨ ROUTE (3) #1 AND #2 GROUND IN 2" SCH 40 PVC CONDUIT UP INTERIOR OF STAGE ALL AND INTO OPEN CEILING SPACE ABOVE STAGE. PROVIDE PULL BOXES AS REQUIRED. SECURE CONDUIT TO STAGE WALL AT 36" INTERVALS. COORDINATE LOCATION OF CONDUIT TO AVOID CONFLICT WITH EXISTING COMPONENTS ALONG WALL AND IN CEILING.
- ⑩ ROUTE (3) #1 AND #2 GROUND IN 2" SCH 40 PVC CONDUIT FROM STAGE INTO GYM AND ALONG GYM WALL IN OPEN CEILING SPACE ABOVE GYM AND TO MECHANICAL ROOM 177. PROVIDE PULL BOXES AS REQUIRED. SECURE CONDUIT TO GYM WALL AT 36" INTERVALS. COORDINATE LOCATION OF CONDUIT TO AVOID CONFLICT WITH EXISTING COMPONENTS.
- ⑪ EXISTING POWER PANEL 'G' IN ROOM 177 OF ELEMENTARY BUILDING TO REMAIN. PROVIDE 208V, 20A, 2-POLE BREAKER IN FIRST AVAILABLE SPACES IN PANEL. CONNECT NEW SITE LIGHTING CONDUCTORS TO CIRCUIT BREAKER.
- ⑫ PROVIDE UNDERGROUND PULL BOX. REFER TO DETAIL 3/E-301.
- ⑬ BY BASE BID, PROVIDE (3) #1 AND #2 GROUND IN 2" SCH 40 PVC CONDUIT.
- ⑭ EXISTING SIDEWALK TO REMAIN. TAKE CARE NOT TO DAMAGE.
- ⑮ BY ALTERNATE BID #2, EXISTING LIGHT FIXTURE AND POLE TO BE REMOVED AND REINSTALLED. TAKE CARE NOT TO DAMAGE. EXISTING CONDUIT TO REMAIN. EXISTING CONDUCTORS TO BE REMOVED BACK TO NEAREST JUNCTION BOX.
- ⑯ BY ALTERNATE BID #2, REINSTALL LIGHT FIXTURE AND POLE ON NEW CONCRETE BASE. PROVIDE/MODIFY CONDUIT AND CONDUCTORS, AS REQUIRED, TO CONNECT FIXTURE TO POWER AND CONTROL CIRCUITRY TO REMAIN. REFER TO DETAIL 1/E301 FOR ADDITIONAL INFORMATION.

#### GENERAL NOTES:

1. ALTHOUGH SOME UTILITIES ARE SHOWN, LOCATION MAY NOT BE EXACT AND NOT ALL MAY BE SHOWN. CONTRACTOR SHALL BE RESPONSIBLE FOR NOTIFYING THE LOCAL UTILITY COMPANIES SEVEN (7) DAYS BEFORE STARTING WORK SHOWN ON THESE DRAWINGS. SOME, BUT NOT ALL, OF THE UTILITIES ENCOUNTERED ON THIS PROJECT CAN BE CONTACTED PRIOR TO CONSTRUCTION BY CALLING THE JOINT UTILITY LOCATING INFORMATION FOR EXCAVATORS (MISSOURI ONE CALL SYSTEM, (MOCS)), PHONE 800-344-7483. THE CONTRACTOR IS RESPONSIBLE FOR CONTACTING MOCS BEFORE BEGINNING CONSTRUCTION AND ANYTIME UTILITY MARKINGS NEED TO BE RE-ESTABLISHED. THE CONTRACTOR SHALL BE RESPONSIBLE FOR LOCATING ALL UTILITIES (CABLE, WATER, GAS, SEWER, ETC.).

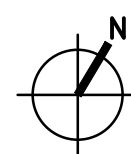

1 LIGHTING SITE PLAN  
E201 SCALE: 1"=30'

30' 15' 0 30'  
SCALE: 1"=30'

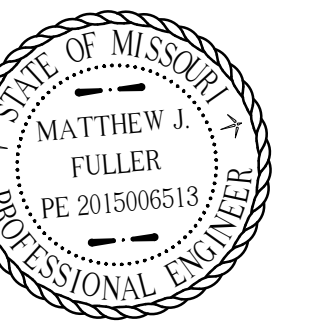

DATE: 04-24-2020  
EXP. DATE: 12-31-2021

**Prairie Engineers, P.C.**  
106 Washington St.  
Keokuk, IA 52632  
(217) 605-0403  
www.prairieengineers.com  
professional design firm no. 184-005965  
© Copyright Prairie Engineers, P.C. 2020



DRAWING DATE	04/24/2020	REVISION 1	
SURVEYED BY		BY & DATE	
DRAWN BY	MJF 04/24/20	REVISION 2	
CHECKED BY		BY & DATE	

LIGHTING SITE PLAN  
RALLS COUNTY R-II SCHOOL DISTRICT  
21622 HIGHWAY 19  
CENTER, MISSOURI 63436

PEI PROJECT NO.	280.2001
PROJECT NAME	RALLS COUNTY R-II PARKING EXPANSION
FILENAME	E201 LIGHTING SITE PLAN.dwg
DRAWING SCALE	1"=30'-0"

E201

13 of 14 sheets



APR 22, 2020, 3:45 PM GILLIAM  
I:\JOBS\2020\280.2001 RALLS COUNTY SCHOOL PARKING LOT & BASEBALL FIELD\DRAWINGS\SHEET\E301 DETAILS.DWG

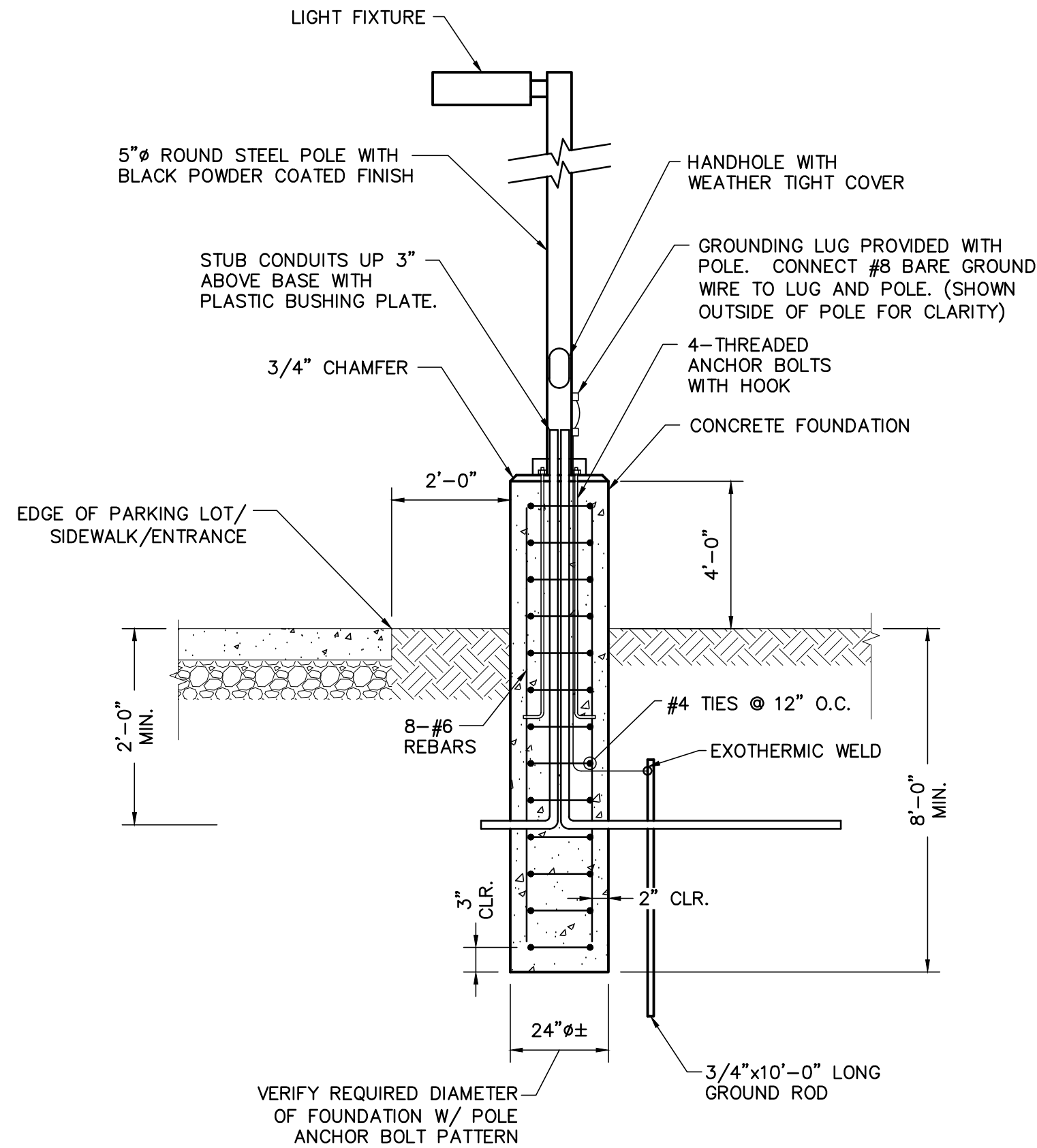

1 LIGHT POLE FOUNDATION DETAIL  
E301 SCALE: NONE

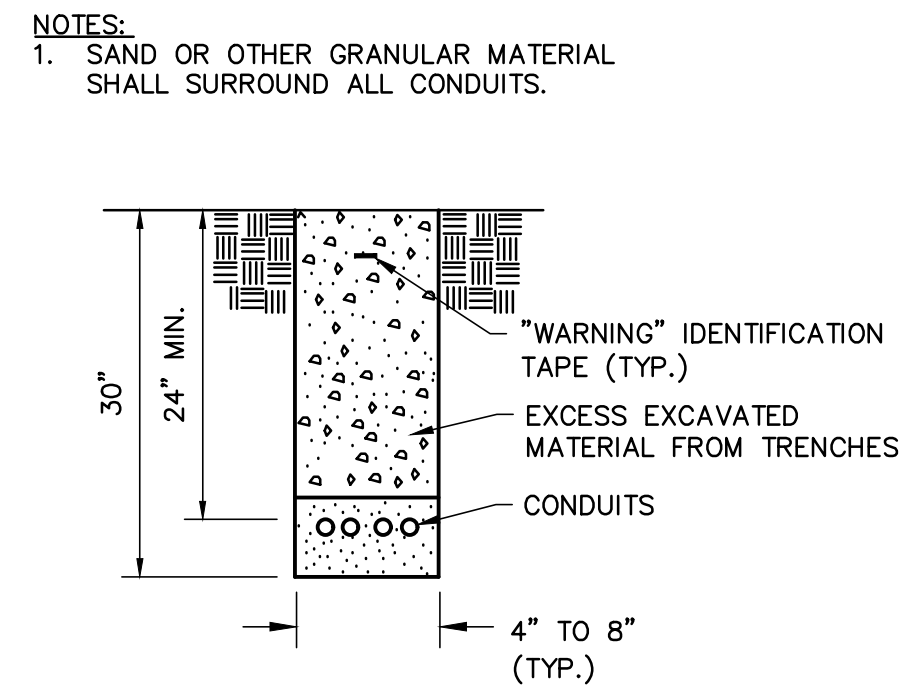

2 ELECTRICAL TRENCH DETAIL  
E301 SCALE: NONE

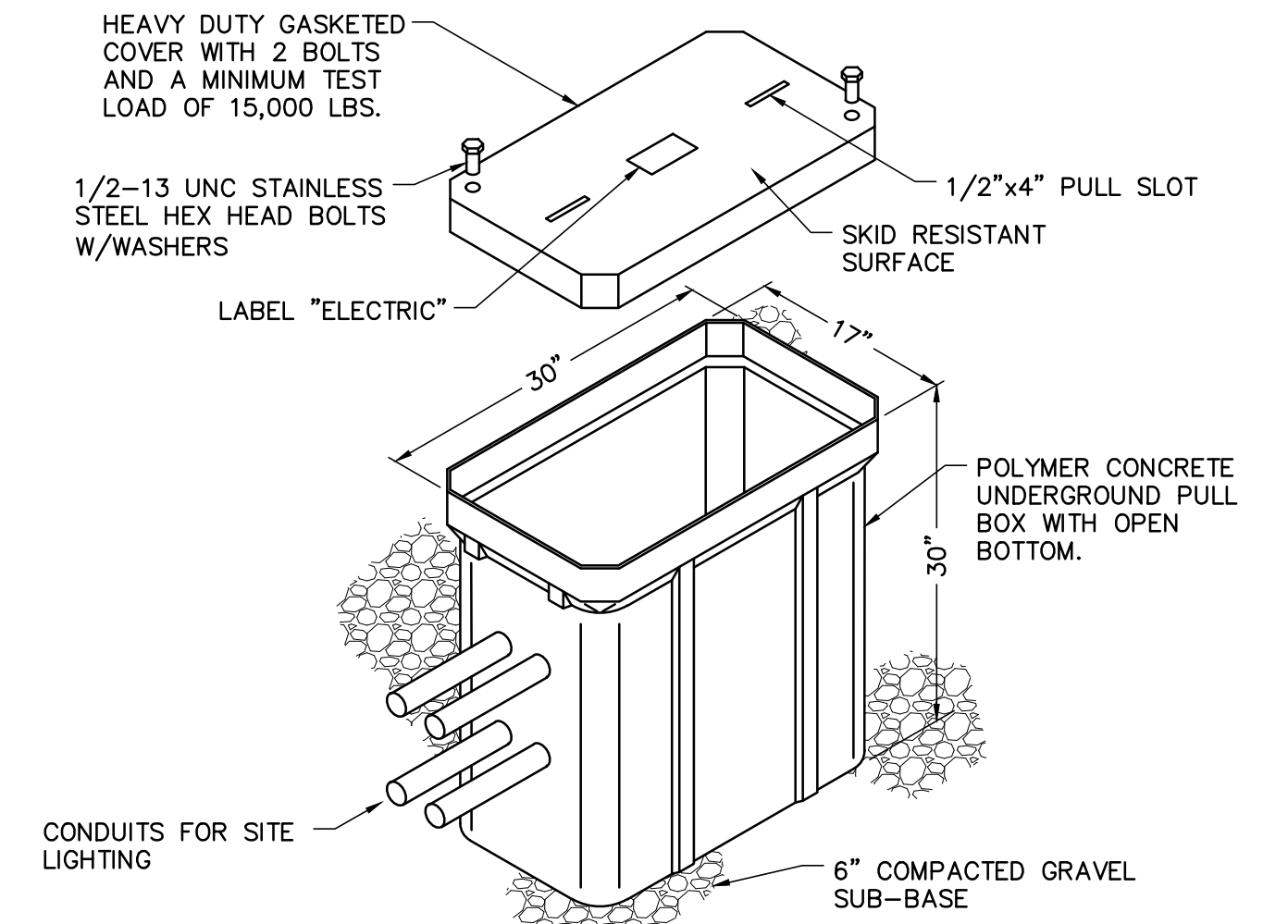

3 UNDERGROUND PULL BOX DETAIL  
E301 SCALE: NONE



DATE: 04-24-2020  
EXP. DATE: 12-31-2021